



41st Annual Scientific Meeting



**Walt Disney World Dolphin
Orlando, Florida**

March 22-25, 2015

***Charles Rardin, MD
Scientific Program Chair***

Jointly Provided by Oakstone Publishing, LLC



Join the SGS 2015 Twitter Conversation

During our 2015 conference all meeting participants are invited to join in the Twitter conversations. Post comments, reports and feedback on the meeting. All you need is a mobile device with an installed Twitter app or a web browser.

Setting up a Twitter Account

Go to www.twitter.com and sign up. You will need to enter information and accept terms of service. You will also need to verify your email address. Twitter provides a wizard set up and ask you to follow five people. It states that it is optional though it does not give you an option to skip it. If you wish to follow the messages at the conference search for #SGS2015.

Install a Twitter Application on your mobile device

Go to <http://twitter.com/download> and select your device. If you do not wish to install an app for Twitter, you can still use Twitter within your web browser.

Sending a Tweet

You can do this with the Twitter app on your mobile device or on the Twitter website. On the website you can post a tweet by clicking on Home and then type inside the left-hand box that says "compose new tweet". You are limited to 140 characters in a single tweet. At the end of each message you must put **#SGS2015**. For example:

Keynote speaker Dr. Smith starting now standing room only - #SGS2015

Please follow these guidelines:

- Messages must be about the meeting content or activities
- Messages cannot contain personal information
- Messages cannot be a personal attack against another person

***We hope that you will join the Twitter conversation
at the meeting in Orlando #SGS2015***

2015 SGS Fellow Scholars

Leading our social network are:

Fabiola Balmir, MD
Sharon Engel-Robertson, MD
Rayan Elkattah, MD
Sukrant Mehta, MD
Christina Saad, MD
Megan Wasson, MD

*Supported by Coloplast, Cooper Surgical, Intuitive Surgical, Karl Storz
Endoscopy-America, Inc., Medtronic, OBG Management.*

— Table of Contents —

Welcome from the President	3
Mission Statement.....	4
Honored Mentors.....	5
Board of Directors.....	15
Scientific Program Committee	16
Walt Disney World Dolphin Hotel Floor Plans	17
Sponsors	19
What You Need to Know	21
General Meeting Information	22
Social Activities	23
CME Information	24
New SGS Members.....	26
Member Candidate Presentations	26
TeLinde Lecture	29
Keynote Lecture	31
Sunday Sessions.....	33
2014 SGS Scientific Program Award Winners.....	34
Monday Sessions	35
Tuesday Sessions	47
Wednesday Sessions.....	55
Video Café.....	63
Non-Oral Posters.....	66
SHARE Donors	78
SGS Membership	87
Active	89
Life	109
Associate.....	114
Honorary	122
In Memoriam	123
Exhibitors.....	125
SGS Administrative Staff.....	132

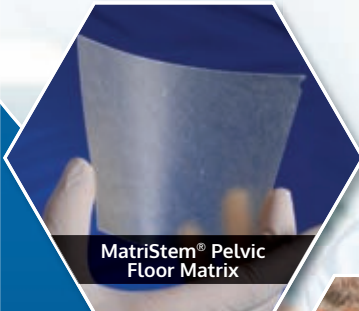

MatriStem® Pelvic
Floor Matrix



Healing Through Regenerative Medicine

REGENERATIVE SOLUTIONS FOR ANTERIOR, POSTERIOR, AND APICAL REPAIRS

Learn More
acell.com/pelvicfloor

Rx ONLY Refer to IFU supplied with each device for indications, contraindications, and precautions.
US Toll-Free: 1-800-826-2926 © 2014 ACell, Inc. All Rights Reserved.
AD-0002.0 08/2014



— Welcome from the President —



As President of the Society of Gynecologic Surgeons, I am pleased to welcome you to the 41st Annual Scientific Meeting in Orlando, Florida, March 22-25, 2015. Charles Rardin and the SGS Program Committee have put together an exciting program for the scientific meeting, postgraduate courses and video sessions.

Remembering that the primary mission of SGS is to promote excellence in gynecologic surgery, the theme of our meeting this year is “Surgeons as Lifelong Learners.” This recognizes the critical role of ongoing education in one’s professional development. The Keynote and TeLinde Speakers are internationally known for their expertise, and we are planning a spirited panel discussion. As always, there will be what promises to be a lively debate, this year focusing on tissue extraction after minimally invasive surgery.

The oral and poster presentations, video sessions and roundtable discussions span the spectrum of gynecologic surgery (including general gynecology, oncology, minimally invasive surgery, reproductive endocrinology and urogynecology). Post-graduate courses on advanced minimally invasive surgical techniques and comprehensive pelvic floor ultrasound highlight the practical role of ongoing personal education. There is also a “how-to” workshop, supported by ABOG, on developing the evidence – based skills that are the hallmark of an accomplished surgeon, as well as a mock NIH review session to help SGS members further their research.

The scientific sessions and social program, as always, provide a unique opportunity to collaborate with old friends and meet new ones, and the attractions of the Orlando area beckon. I look forward to seeing you in Orlando in 2015, as we all become Lifelong Learners, so that we can continue to provide the best surgical care to our patients.

Most Sincerely,

A handwritten signature in dark ink, appearing to read "Stephen Metz MD". The signature is fluid and cursive.

Stephen Metz, MD
President

— Mission Statement —

The mission of the Society of Gynecologic Surgeons is to promote excellence in gynecologic surgery through acquisition of knowledge and improvement of skills, advancement of basic and clinical research, and professional and public education.

SGS is a Society with a strong belief in mentorship. On the following pages we are pleased to recognize the mentors who have been honored by those whose careers they helped develop while also fostering the mission of SGS.



—Honor Your Mentor—

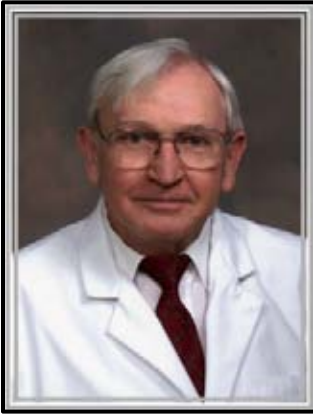

W. Allen Addison, MD

The time you spent with us and the teaching you bestowed upon us changed our lives. We love you and are forever deeply indebted.

Robert L. Harris, MD; Geoffrey W. Cundiff, MD;
James P. Theofrastous, MD



Arnold Advincula, MD

No words or awards could ever fully express our gratitude for your mentorship. Thank you for continuing to inspire us and the generations to come!

Advincula MIGS Fellows
2003-2016

—Honor Your Mentor—



Alfred E. Bent, MD

You have had such a huge impact on all of our careers and lives. We are eternally grateful.

Geoffrey Cundiff, MD; Mary T. McLennan, MD; Mark Ellerkmann, MD, Mikio A. Nihira, MD MPH; Joan Blomquist, MD



Rick Bump, MD

Rick, The years at Duke shaped us all. You continue to be an incredibly important influence on all of our careers for which we are grateful.

Geoffrey Cundiff, MD;
Bob Harris, MD;
Jim Theofrastous, MD

—Honor Your Mentor—



Ralph R. Chesson, MD

To Ralph: Thank you for being our mentor, teacher, supporter and friend. Your contributions to the field Urogynecology, and our individual training, have been invaluable.

Ahmet Bedestani, MD; Roberta E. Blandon, MD;
Peter G. Drewes, MD; Karolynn T. Echols, MD; Mohamed A.
Ghafar, MD; Cynthia Hall, MD; Barry Hallner, MD;
Okey Ibeanu, MD, MPH; Sharon Knight, MD;
Lise Rehwaldt, MD; Abbas Shobeiri, MD; Ambereen Sleemi, MD,
MPH; Karen Soules, MD; Babak Vakili, MD; Briana Walton, MD;
Yong T. Zheng, MD



Jeffrey L. Cornella, MD

Thank you for contributions to each of our professional careers!

Jaime Long, MD; Wesley Hilger, MD;
Dobie Giles, MD; Jennifer Klauschie, MD;
Kristina Butler, MD; Antonio Pizarro, MD;
Abraham (Nick) Morse, MD; Robert
Hammer, MD; Andrew Walter, MD;
Rosanne Kho, MD; Johnny Yi, MD

— Honor Your Mentor —



John B. Gebhart, MD

In surgery, most of our knowledge is based on what we learn from others. Thank you for being a great surgeon, mentor and friend!

Sherif El-Nashar, MD; Emanuel Trabuco, MD;
Roberta Blandon, MD; Christine Heisler, MD;
John Occhino, MD; Elizabeth Casiano, MD; Joshua Woelk, MD;
Shunaha Kim Fine, MD; Mallika Anand, MD;
Ruchira Singh, MD; Jennifer Schmitt, DO



Robert L. Holley, MD

With the Highest Gratitude and Respect.

UAB FPMRS Fellows 2007-2014

— Honor Your Mentor —



Mickey M. Karram, MD

Thank you for sharing your knowledge and expertise. We are all grateful to have been trained by you. With great admiration, DZ, JE, CV, AP, MB, & JM

Your Urogynecology Fellows
1995-2014



Raymond A. Lee, MD

The Division of Gynecologic Surgery offers our sincere appreciation for your leadership in gynecologic surgery, your commitment to excellence, and your steadfast integrity. God bless.

Division of Gynecologic Surgery –
Mayo Clinic

—Honor Your Mentor—



Joseph Markee, PhD

*The mentor without whose guidance
I would not have become a
physician.*

W. Allen Addison, MD



Deborah L. Myers, MD

*Deb, Thank you for your mentorship
that allowed us to develop into the
physicians we have become. You're
the best.*

With love: Peter Rosenblatt, MD; Christine
LaSala, MD; Lily Arya, MD, MS; Jeff
Clemons, MD; Vivian Aguilar, MD; Eric

Sokol, MD; Vivian Sung, MD, MPH; Renee Ward, MD; Elisabeth
Erekson, MD, MPH; Kyle Wohlrab, MD; Blair Washington, MD,
MHA; Peter Jeppson, MD; Nicole Korbly, MD; Anna Pilzek, MD;
Paul Tulikangas, MD; Robert Gutman, MD; Nadine Kassis, MD;
Cassandra Carberry, MD; Star Hampton, MD

— Honor Your Mentor —



Karl C. Podratz, MD, PhD

The Division of Gynecologic Surgery offers our sincere appreciation for your surgical acumen, influential research, and above all, selfless mentorship over the past several decades.

Division of Gynecologic Surgery –
Mayo Clinic



Robert F. Porges, MD

We are forever grateful for the mentorship of Dr. Robert Porges. His passion will never be forgotten and his legacy will live on.

Cassandra L. Carberry, MD, MS; Scott W. Smilen, MD;
Christina Kwon, MD; Brittany Star Hampton, MD;
Rebecca Margulies, MD; Jeanette Rivera, MD;
Laura Kim, MD; Arash Rahi, MD, MSc, FACOG;
Tirsit Asfaw, MD; Saya Segal, MD, MSCE;
Katherine Sandhu, MD; Brian Hines, MD; Ellen Connor, MD

— Honor Your Mentor —



**Holly E. Richter,
PhD, MD**

*With the Highest Gratitude and
Respect*

UAB FPMRS Fellows 2007-2014

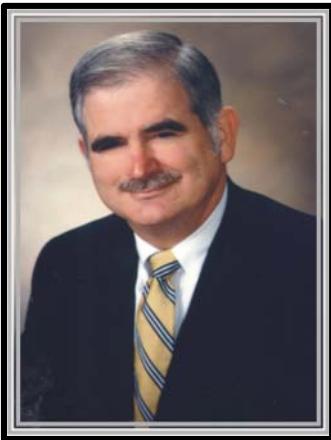

John A. Rock, MD

*A great honor to be a former
fellow. The lessons learned
continue to shape me personally
and professionally. Your legacy
lives on through your fellows.
Many regards, a grateful fellow.*

Lisa M. Peacock, MD

— Honor Your Mentor —



Peter Rosenblatt, MD

*Thank you, Peter, for teaching a
foundation of surgical tradition,
with which to think creatively*

Charley Rardin, MD



R. Edward Varner, MD

*With the Highest Gratitude and
Respect*

UAB FPMRS Fellows 2007-2014

— Honor Your Mentor —



Mark Walters, MD

Your leadership has advanced the field of urogynecology. Your mentorship leaves a legacy that will shape generations of urogynecologists to come. Thank you for everything.

Marie Paraiso, MD; Paul Tulikangas, MD; Tristi Muir, MD; James Whiteside, MD; Andrew Sokol, MD; Kevin Stepp, MD; A. Marc Ashby, MD; Chi Chiung Grace Chen, MD; Amy Park, MD; Beri Ridgeway, MD; Gouri Diwadkar, MD; Anna Frick, MD; Tyler Muffly, MD; Elena Tunitsky-Biton, MD; Nathan Kow, MD; Ellen Solomon, MD; Cecile Unger, MD; Karl Jallad, MD; Lauren Siff, MD; Jo Hill, MD



The Residents and Fellows Who Taught Me So Much

Thanks for the memories.

W. Allen Addison, MD

—Board of Directors—

Executive Committee

President - Stephen Metz, MD

President-Elect - Andrew J. Walter, MD

Secretary/Treasurer - Vivian Sung, MD

Assistant Secretary/Treasurer - John Gebhart, MD

Immediate Past President - Holly E. Richter, MD

Past President - Mark D. Walters, MD

Member-At-Large - Arnold P. Advincula, MD

Member-At-Large - Ted Lee, MD

Executive Director - Nancy Frankel, MBA

Committee Chairs

Membership Committee- Marc Toggia, MD

Bylaws Committee - Lily A. Arya, MD

Research Committee - Miles Murphy, MD

Education Committee - Oz Harmanli, MD

Postgraduate Committee - Kris Strohbehn, MD

Scientific Program Committee - Charles Rardin, MD

— 2015 Scientific Program Committee —

Charles Rardin, Scientific Program Chair

Eric Sokol, Scientific Program Co-Chair

Stephen Metz, SGS President

Holly Richter, SGS Immediate Past President

Andrew Walter, SGS President Elect

Cheryl Iglesia, Past Scientific Program Chair

Brittany Star Hampton – Abstract Review Chair

Peter Rosenblatt – Video Review Chair

Lennie Siegel – SGS Staff

Nancy Frankel – Executive Director

Video Reviewers

Peter Rosenblatt, Chair

Grace Chen

Daniel Gruber

Wesley Hilger

Christine LaSala

Jaime Long

Gregory Raff

Karl Tamussino

Abstract Reviewers

Brittany Star Hampton, Chair

Rony Adam

Michael Diamond

Robert Gutman

Kim Kenton

Sangeeta Mahajan

Kristen Matteson

Jeffrey Mangel

Wilma Larsen

Ted Lee

Megan Schimpf

Dolphin Ballrooms

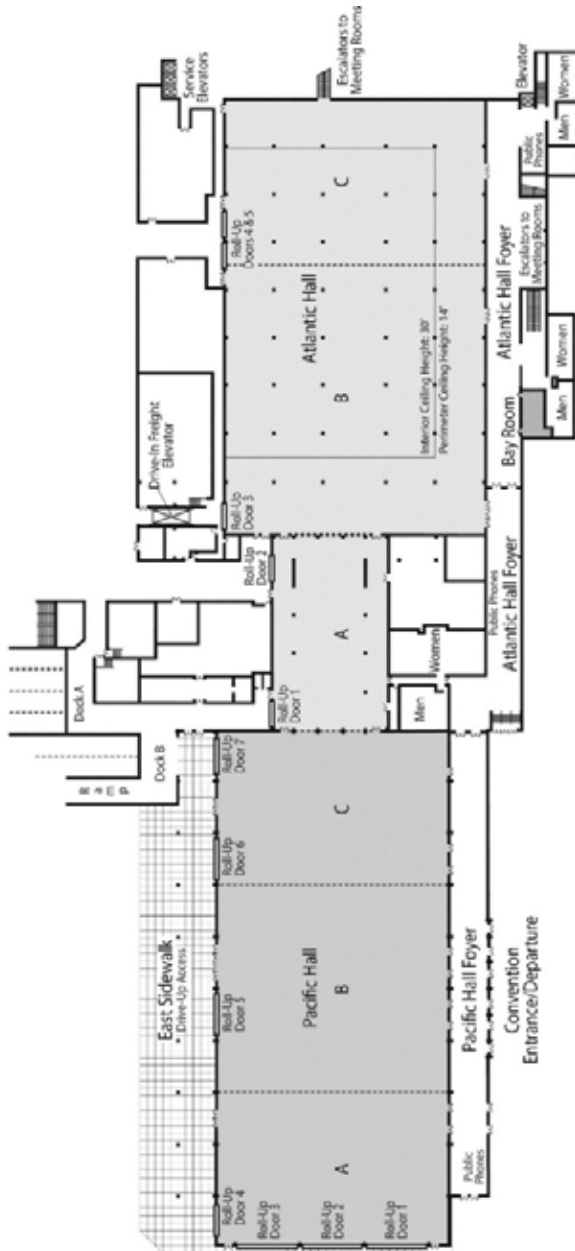

Dolphin Meeting Rooms

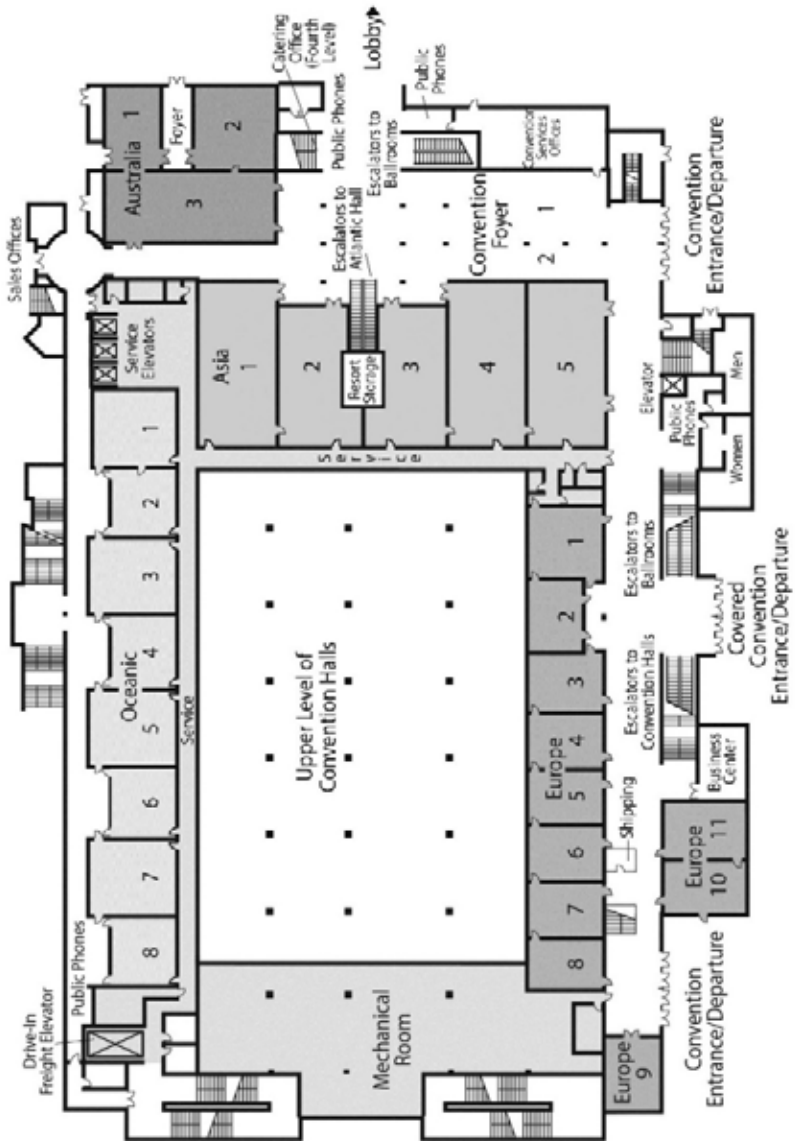

— Sponsors —

SGS thanks our premier sponsors for their support.

Gold Sponsorship



Silver Sponsorship



— Sponsors —

Bronze Sponsorship



Industry Events (Non-CME)

Monday, March 23, 6:30 AM – 7:15 AM **Asia 4**

Industry Expert Breakfast Symposium - “Championing
Change for Refractory OAB Patients”

Speakers: Michael J. Kennelly, MD, FACS

Marc R. Togli, MD

Supported by Uroplasty

Monday, March 23, 11:50 AM – 12:20 PM **Pacific Hall B**

Presentation Theater in the Exhibit Hall

“Experience the New Vision for Hysteroscopic Tissue
Removal: The Symphon™ System”

Speakers: Andrew I. Brill, MD and Amy L. Garcia, MD

Supported by Boston Scientific

Wednesday, March 25, 6:30 AM – 7:25 AM **Asia 4**

Industry Expert Breakfast Symposium -

OFIRMEV (acetaminophen) Injection: An Acute Pain
Management Tool for the OBGYN

Speaker: Mark E. Melton, DO, FACOOG

Supported by Mallinckrodt Pharmaceuticals

— ***What You Need to Know*** —

Welcome to the SGS 2015! So that you may take full advantage of everything this meeting has to offer, please note the following:

Registration Hours: Registration will be open:

Saturday, March 21: 5:00 PM – 7:00 PM	Asia 2
<i>(Postgraduate Courses Only)</i>	
Sunday, March 22: 6:00 AM – 7:00 PM	Asia 2
Monday, March 23: 6:00 AM – 4:00 PM	Atlantic Hall Foyer
Tuesday, March 24: 6:00 AM – 1:30 PM	Atlantic Hall Foyer
Wednesday March 25: 6:00 AM – 12:00 PM	Atlantic Hall Foyer

Bar Codes: Your attendee badge will have a bar code. This bar code will make your interactions with the exhibitors more efficient. Each coded badge contains the information that the exhibitors need to register you with their company and to ensure that you are identified correctly in their records.

Mobile Apps: We are pleased to introduce the SGS mobile meeting app for the 2015 scientific meeting. Search for specific abstract authors and sessions, abstracts, and get updates on any changes.

The mobile itinerary app is available as both a native iOS (iPhone/iPad) app through the iTunes App Store, or as an HTML5 Web app for all major mobile devices (iPhone/iPad, Android, Blackberry 7 and above). Once either version is downloaded to your device, it can be run without the need for an active Internet connection. In addition, you can sync an itinerary that you created online with the app by entering your unique itinerary name.



For optimal use, we recommend: iPhone 3GS, iPod touch (3rd generation+), iPad iOS 4.0 or later. You can download the MyItinerary app by searching for “ScholarOne” in the App Store directly from your mobile device. Alternatively, you can access the link below or scan the QR code to access the iTunes page for the app.

<http://itunes.apple.com/us/app/scholarone-my-itinerary/id497884329?mt=8>

***Once the MyItinerary app is downloaded, select the meeting
“SGS 41st Annual Scientific Meeting”***

— **General Meeting Information** —

Registration Information

Saturday, March 21: 5:00 PM – 7:00 PM

Asia 2

(Postgraduate Courses Only)

Sunday, March 22: 6:00 AM – 7:00 PM

Asia 2

Monday, March 23: 6:00 AM – 4:00 PM

Atlantic Hall Foyer

Tuesday, March 24: 6:00 AM – 1:30 PM

Atlantic Hall Foyer

Wednesday March 25: 6:00 AM – 12:00 PM

Atlantic Hall Foyer

Speaker Ready Room Information/

Video Café/Internet Café

Pacific Hall C

Sunday, March 22: 4:00 PM– 7:00 PM

Monday, March 23: 6:30 AM – 7:00 PM

Tuesday, March 24: 6:30 AM – 6:00 PM

Wednesday, March 25: 6:30 AM – 12:00 PM

Exhibit Set-up Times

Sunday, March 22, 3:00 PM– 9:00 PM

Pacific Hall B

Monday, March 23 6:00 AM – 8:30 AM

Pacific Hall B

Exhibit Hall Hours

Pacific Hall B

Monday, March 23: 9:00 AM – 2:30 PM

Monday, March 23: 7:00 PM – 8:30 PM

Tuesday, March 24: 9:00 AM – 1:00 PM

Poster Set-up Time

Sunday, March 22: 4:00 PM – 9:00 PM

Pacific Hall C

— **Social Activities** —

Sunday, March 22

6:00 PM – 7:00 PM

Welcome Reception *Asia 1*
(included with registration)

Monday, March 23

6:45 PM – 7:15 PM

Awards Ceremony *Pacific Hall A*

7:15 PM – 8:30 PM

President's Reception *Pacific Hall B*
(All SGS attendees, guests and exhibitors are invited.)

Tuesday, March 24

1:45 PM – 6:45 PM

SGS Golf Tournament
(Ticketed Event - \$179)
Disney's Lake Buena Vista Golf Course
Bus Leaving from Covered Convention Entrance
Across from Europe 2

2:00 PM – 6:00 PM

Paddleboard Cruisin' Winter Park Chain
(Ticketed Event - \$130)
Bus Leaving from Covered Convention Entrance
Across from Europe 2

2:30 PM – 6:00 PM

SGS Tennis Tournament
(Ticketed Event - \$75)
Meet at Walt Disney World Swan & Dolphin
Tennis Courts

7:00 PM – 8:30 PM

Mojito Night in the Caribbean!
(Ticketed Event - \$80)
Walt Disney World Swan & Dolphin Crescent
Terrace

— CME Information —

Program Chair: Charles Rardin, MD

Target Audience: Gynecologic Surgeons

Program Goal: The goal of the annual scientific meeting is to provide member and non-member attendees with a forum for the latest and most innovative developments in gynecologic surgery. This will be accomplished through lecture, slide, video and poster presentations. Oral presentations are followed by a discussion and a question and answer session.

To Obtain Your CME: CME evaluations will be conducted electronically. You will receive an email within one week following the end of the SGS meeting requesting you to fill out an evaluation to attain your CME credits. Even if you do not wish to request CME please fill out the evaluation questions. Your feedback is critical to us to help identify topics and speakers of interest to you. In order to receive CME credits, evaluations must be completed.

If your preferred email address is not in your current SGS profile, please stop at the SGS registration desk in the Atlantic Hall Foyer during the meeting to update your email address. After the meeting email Melinda@sgsonline.org to update your contact information.

Learning Objectives

At the conclusion of the meeting attendees should be able to:

1. Choose when the robotic approach is indicated for benign gynecology and consider cost-benefit analysis
2. Recognize that shared decision making is a necessary part of the informed consent process.
3. Summarize the limited outcome data of recent gynecologic surgery technologies.
4. Apply knowledge of pelvic anatomy to minimize peri-operative complications.

— CME Information —

5. Classify potential ethical issues surrounding elective and cosmetic gynecologic procedures.
6. Identify national gynecologic surgical outcome database and registry initiatives.

ACCREDITATION

Accreditation Statement: This activity has been planned and implemented in accordance with the accreditation requirements and policies of the Accreditation Council for Continuing Medical Education through the joint providership of Oakstone Publishing, LLC and The Society of Gynecologic Surgeons. The Oakstone Publishing, LLC is accredited by the ACCME to provide continuing medical education for physicians.

Designation Statement: Oakstone Publishing, LLC designates this live activity for a maximum of 20.50 *AMA PRA Category 1 Credit(s)*[™]. Physicians should claim only the credit commensurate with the extent of their participation in the activity.

The 20.50 credits are inclusive of 1) 12.75 credits for Scientific Meeting 2) 1.75 credits for Videofest 3) 1.00 credit for Academic Roundtable 4) 3.75 credits for Surgical Tutorial Postgraduate Course 5) 5.25 credits for Ultrasound Postgraduate Course.

Disclosure and Conflicts of Interest

Disclosure: Oakstone Publishing, LLC adheres to ACCME Essential Areas, Standards, and Policies regarding industry support of continuing medical education. Disclosure of the Activity Director(s), Planning Committee Members(s), Speaker(s), Author(s) or Anyone in a Position to Control Content regarding commercial relationships will be made known at the activity. Speakers are required to openly disclose any limitations of data and/or any discussion of off-label, experimental, or investigational uses of drugs or devices in their presentations.

Resolution of Conflicts of Interest

In accordance with ACCME Standards for Commercial Support of CME, Oakstone Publishing, LLC will implement mechanisms, prior to the planning and implementation of this CME activity, to identify and resolve any conflicts of interest for all individuals in a position to control content of this CME activity.

— Welcome to the New SGS Members —

Husam Abed, MD
Detroit, MI

Sarah Collins, MD
Chicago, IL

Tola Fashokun, MD
Baltimore, MD

Robert Flora, MD
Southfield, MI

Dobie Giles, MD
Madison, WI

Elliot Greenberg, MD
West Springfield, MA

Sarah Kane, MD
Louisville, KY

Tyler Muffly, MD
Aurora, CO

Sesh Kasturi, MD
Sacramento, CA

Rosanne Kho, MD
New York, NY

Christina Lewicky-Gaupp, MD
Chicago, IL

Saifuddin Mama, MD, MPH
Camden, NJ

Mamta Mamik, MD
New York, NY

Anna McNanley, MD
Maple Grove, MN

Douglas Miyazaki, MD
Winston Salem, NC

David Shveiky, MD
Jerusalem, Israel

Member Candidate Presentations

Gary Sutkin, MD - Non-Oral Poster 85
LEARNING THEORIES APPLIED TO MICRO-TEACHING MOMENTS
IN THE OPERATING ROOM. G. Sutkin; E. B. Littleton; S. Kanter

Janet Li, MD - Videofest 13
ROBOTIC APPROACH TO EXCISION OF A RECURRENT
RETROPUBIC SLING EROSION INTO THE BLADDER. J. Li;
R. LeFevre

Altis®

Single Incision Sling System



Now even less is more.

Proven product legacy

Same mesh material as used in the Aris® and Supris® sling systems

Predictable placement

Helical type introducer allows for ease of passage and placement

Precise adjustability

Anchoring allows for bi-directional tensioning

www.AltisSIS.com

The results are in. Visit us at our booth to see the 24-month IDE study data.

Indications

The Altis Single Incision, Aris® Transobturator and Supris® Retropubic Sling Systems are indicated for the treatment of female stress urinary incontinence (SUI) resulting from urethral hypermobility and/or intrinsic sphincter deficiency (ISD).

Contraindications

It is the responsibility of the surgeon to advise the prospective patients or their representatives, prior to surgery, of the contraindications associated with the use of the Altis, Aris or Supris slings.

Warnings and Precautions

It is the responsibility of the surgeon to advise the prospective patients or their representatives, prior to surgery, of the possible warnings and precautions associated with the use of this product and the associated surgical risks. Altis, Aris and Supris Sling Systems should only be used by surgeons who are qualified to perform this type of surgery, have experience in the surgical treatment of SUI and who are familiar with the use of non-absorbable mesh and the specific insertion technique. The patient should be informed that any future pregnancy may negate the benefits of this surgical procedure and the patient may become incontinent again. Patients should immediately report any onset of bleeding, pain, vaginal discharge or sign of infection that occurs at any time.

Adverse Effects

Potential adverse reactions are those associated with surgery using implantable synthetic mesh materials. As with all foreign bodies, the Altis, Aris, Supris sling is likely to exacerbate any existing infection. Transitory local irritation at the wound site and a foreign body response may occur. There is also the risk of complete failure of the procedure resulting in continued incontinence due to incomplete support or overactive bladder. The occurrence of these events may require partial or complete removal of the sling. Patients should be monitored regularly after the device has been implanted for immediate treatment of any adverse reaction.

See the device manual for detailed information regarding the implant procedure, warnings /precautions, adverse reactions, prior to using this product. For further information, call Coloplast Corp at 1-800-258-3476 and/or consult the company website at www.coloplast.us.

Caution: Federal law (USA) restricts this device to sale by or on the order of a physician.

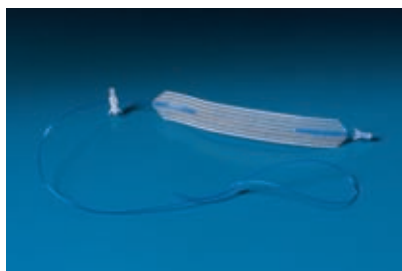

Featured Speakers

— TeLinde Lecture —



Sandra Ann Carson, MD, FACOG
Vice President, Education
American College of Obstetricians and
Gynecologists
Washington, DC

Sandra A. Carson, MD is Vice President for Education at the American College of Obstetricians and Gynecologists. Before that she was Professor, Department of Obstetrics and Gynecology, and Director of the Division of Reproductive Endocrinology and Infertility at the Warren Alpert Medical School of Brown University.

Dr. Carson earned her medical degree from Northwestern University Medical School in Chicago, Illinois, completing her residency there in Obstetrics and Gynecology. She completed her fellowship training in Reproductive Endocrinology and Infertility at the University of Chicago.

Dr. Carson assumes clinical activities of assisted reproductive technology procedures, gynecological treatments, recurrent spontaneous abortion and surgery. An accomplished surgeon, she has designed surgical instruments for hysteroscopic surgery. She has been recognized for her clinical expertise in Best Doctors in America for more than 10 years and has been included in *Good Housekeeping's* "401 Best Doctors for Women", "*Rhode Island's Top Doctors*" list, the *Guide to America's Top Obstetricians and Gynecologists* by the Consumers' Research Council of America, and Castle Connolly's *America's Top Doctors*.

A sought-after national and international lecturer, Dr. Carson has published over 130 peer-reviewed scientific papers in the field of reproductive medicine and over 50 chapters in medical texts and 6 books, including *The ASRM Couple's Guide to Infertility*. She has served as an associate editor for the *American Journal of Obstetrics and Gynecology* and editor in-chief of *Sexuality, Reproduction and Menopause*.

Dr. Carson has mentored multiple students and faculty throughout her career and has held many national educational offices. She served as

— TeLinde Lecture —

Vice President of the American Board of Obstetrics and Gynecology (ABOG) and Director of the Division of Reproductive Endocrinology and Infertility. She was elected Vice President of the American College of Obstetricians and Gynecologists (ACOG), President of the American Society for Reproductive Medicine (ASRM), Secretary-Treasurer of the Society for Gynecological Investigation (SGI) and Secretary-Treasurer of the American Gynecologic Club (AGC). She was Chairman of FDA's Reproductive Drugs Advisory Committee and served as a consultant to FDA's Center for Devices and Radiological Health and the President's Council on Bioethics.

Finally, Dr. Carson's research has been funded by the National Institutes of Health for 18 years. She completed her tenure on the NICHD Council and is a member of its Strategic Planning Committee. Her research development, the "Artificial Human Ovary" was chosen as one of the top ten medical breakthroughs in 2010 by *Time* magazine and was named a Rhode Island 2011 Innovation of the Year by *Providence Business News*.

Dr. Carson will present "Teaching Medicine and Surgery to Sesame Street Graduates?" on Tuesday at 10:25 AM.

—Keynote Lecture—



David A. Grimes, MD, FACOG, FACPM
Clinical Professor, Department of
Obstetrics and Gynecology
UNC School of Medicine
Chapel Hill, North Carolina

David Grimes is one of a small number of U.S. physicians Board certified in both obstetrics and gynecology and in preventive medicine. He obtained his undergraduate degree in biology from Harvard then attended medical school as a Morehead Fellow at the University of North Carolina. He completed his residency in obstetrics and gynecology at that institution, interrupted by two years at the U.S. Centers for Disease Control and Prevention.

Dr. Grimes has had a dual career in clinical ob/gyn and in preventive medicine for the past three decades. He served as an epidemiologist at the Centers for Disease Control for nine years. He has also been a faculty member in four medical schools: Emory University, University of Southern California, University of California-San Francisco, and University of North Carolina. He has received teaching awards from medical students and residents at each of these schools. Through the auspices of the Berlex Foundation and Exxcellence Foundation Faculty Development Courses, he has taught research methods to over 2000 obstetricians/gynecologists in the U.S. Through the Centers for Disease Control and Prevention and FHI, he has taught research methods to physicians and scientists in Kenya, Ethiopia, India, Egypt, and Bangladesh. In 2002, he and colleague Kenneth F. Schulz, Ph.D., M.B.A. authored an 11-part series on research methods in *The Lancet*. A second installment of 5 additional articles appeared in *The Lancet* in 2005. These 16 essays were published by Elsevier in 2006 (*The Lancet Handbook of Essential Concepts in Clinical Research*). He is also an editor of *Management of Unintended and Abnormal Pregnancy: Comprehensive Abortion Care* published by Wiley-Blackwell in 2009.

Dr. Grimes' research interests have focused on fertility regulation, technology assessment, sexually transmitted diseases, and clinical epidemiology. He has published 390 peer-reviewed articles, fifty textbook

—Keynote Lecture—

chapters, and ten books. In 1994, he received the Issue of the Year Award and in 1997 the Distinguished Service Award from the American College of Obstetricians and Gynecologists. In 2006, he was elected to the Institute of Medicine of the National Academies of Science. He was elected an Honorary Fellow of the Royal College of Obstetricians and Gynaecologists in 2007. He currently serves as Clinical Professor in the Department of Obstetrics and Gynecology at UNC.

Dr. Grimes will present “Is Teaching Evidence-Based Surgery Possible?” on Monday at 10:50 AM

— Sunday, March 22, 2015 —

Sunday, March 22

6:00 AM – 7:00 PM

Registration**

In Front of Asia 2

Postgraduate Courses

8:00 AM – 2:30 PM

Comprehensive Pelvic Floor Ultrasonography; Transperineal, Endovaginal and Endoanal imaging

Asia 5

*Supported by grants from Halo Medical Technologies
and BK Ultrasound*

8:00 AM – 12:00 PM

Laparoscopic, Robotic and Vaginal Approach to Difficult Hysterectomy - A Surgical Tutorial on Strategies and Techniques

Asia 3

8:00 AM – 2:00 PM

SGS-ABOG Workshop: Building Evidence-Based Medicine Skills in Gynecology

Asia 4

*Supported by a grant from the American Board of
Obstetrics and Gynecology*

2:00 PM – 6:00 PM

NIH Application Training Camp

Asia 3

*Supported by SGS Research Donations and a generous
donation from Holly E. Richter, PhD, MD*

6:00 PM – 7:00 PM

Welcome Reception

Asia 1

— 2014 SGS Scientific Program Award Winners —



“Pelvic Organ Prolapse in a Cohort of Women Treated for Stress Urinary Incontinence”

*Peggy Norton, MD
University of Utah
Salt Lake City, UT*



“Impact of Robotic Technology on Hysterectomy Route and Associated Implications for Resident Education”

*Peter Jeppson, MD
Brown University
Providence, RI*



“Small Bowel Surgery for the Benign Gynecologist” (video)

*Tyler Muffly, MD
University of Colorado
Englewood, CO*



“Randomized Placebo-Controlled Clinical Trial of the Use of Paracervical Block of Bupivacaine with Epinephrine in Laparoscopic Supracervical Hysterectomy”

*Rachel Barr, MD
Mount Sinai School of Medicine
New York, NY*

Monday, March 23

— **Monday, March 23, 2015** —

Monday

6:00 AM – 4:00 PM **Registration**
Atlantic Hall Foyer

6:30 AM – 7:30 AM **Poster Viewing/Video Café with
Continental Breakfast**
Pacific Hall C

7:30 AM – 7:45 AM **Welcome and Recognize New SGS Members**
Pacific Hall A

7:45 AM – 9:10 AM **First Scientific Session**
Moderators: Stephen Metz, MD and Jaime Long, MD
Pacific Hall A

7:45 AM **Oral Presentation 01**
**EFFECTS OF PREOPERATIVE DEXAMETHASONE
ON POSTOPERATIVE QUALITY OF RECOVERY
FOLLOWING VAGINAL RECONSTRUCTIVE
SURGERY: A RANDOMIZED CONTROLLED TRIAL**
R. N. Pauls; C. C. Crisp; S. Oakley; L. B. Westermann; D.
Mazloomdoost; S. D. Kleeman; V. C. Ghodsi; M. V.
Estanol
Division of Urogynecology and Reconstructive Pelvic
Surgery, Good Samaritan Hospital, Cincinnati, OH

DISCUSSANT: Hilary J. Cholhan, MD

8:00 AM **Oral Presentation 02**
**TO PACK OR NOT TO PACK? A RANDOMIZED TRIAL
OF VAGINAL PACKING FOLLOWING PELVIC
RECONSTRUCTIVE SURGERY**
L. B. Westermann¹; C. C. Crisp¹; S. Oakley¹; D.
Mazloomdoost¹; S. D. Kleeman¹; J. M. Benbouajili²; V. C.
Ghodsi²; R. N. Pauls¹
1. Urogynecology, TriHealth Good Samaritan Hospital,
Cincinnati, OH, 2. Hatton Research Institute, TriHealth,
Cincinnati, OH

DISCUSSANT: Paul Magtibay, MD

8:15 AM **Oral Presentation 03**
**A RANDOMIZED COMPARISON OF SINGLE INCISION
MID-URETHRAL SLING (MINIARC™) AND
TRANSOBTURATOR MID-URETHRAL SLING**

— **Monday, March 23, 2015** —

**(MONARC™) FOR TREATMENT OF STRESS
URINARY INCONTINENCE: 2-YEAR CLINICAL
OUTCOMES**

J. Roovers¹; R. Schellart²; F. van der Aa³

1. Gynaecology, AMC Amsterdam, Amsterdam, Netherlands, 2. Gynaecology, Kennemer Gasthuis, Haarlem, Netherlands, 3. Urology, UZ Gasthuisberg, Leuven, Belgium

DISCUSSANT: Michael Heit, MD

8:30 AM

Oral Presentation 04

**HOW PATIENT RISK FACTORS AND HOSPITAL
VARIATION INFLUENCES SURGICAL SITE
INFECTION FOLLOWING HYSTERECTOMY**

D. M. Morgan¹; K. M. Streifel²; N. S. Kamdar³; C. W. Swenson¹; M. D. Pearlman¹; D. E. Fenner¹; D. A. Campbell⁴

1. Obstetrics & Gynecology, University of Michigan, Ann Arbor, MI, 2. Obstetrics & Gynecology, St Joseph Mercy Hospital, Ann Arbor, MI, 3. Biostatistics, University of Michigan, Ann Arbor, MI, 4. Surgery, University of Michigan, Ann Arbor, MI

DISCUSSANT: Kristen Matteson, MD

8:45 AM

Oral Presentation 05

**TOPAS™: A NEW MODALITY FOR THE TREATMENT
OF FECAL INCONTINENCE IN WOMEN**

D. Fenner¹; V. Lucente²; M. Zutshi³; P. Culligan⁵; A. Mellgren⁴

1. OBGYN, University of MI, Ann Arbor, MI, 2. Institute for Female Pelvic Medicine, Bethlehem, PA, 3. Surgery, Cleveland Clinic, Cleveland, OH, 4. Surgery, University of Illinois, Chicago, IL, 5. Obstetrics, Gynecology, and Reproduction, Mount Sinai School of Medicine, Morristown, NJ

DISCUSSANT: Holly E. Richter, MD, PhD

9:00 AM

Video Presentation 01

**LAPAROSCOPIC URETEROLYSIS: TECHNIQUES
AND APPROACHES TO URETER IDENTIFICATION
AND DISSECTION**

C. R. King²; S. Mansuria¹

— Monday, March 23, 2015 —

1. OB/GYN, Magee-Womens Hospital of UPMC, Pittsburgh, PA, 2. OB/GYN, University of Wisconsin-Madison, Madison, WI

DISCUSSANT: Brittany Star Hampton, MD

9:10 AM - 9:40 AM Refreshments/Exhibits/View Posters
Exhibit Hall – Pacific Hall B

9:40 AM - 11:35 AM Second Scientific Session
Moderators: Ralph Chesson, MD and
Stephanie Molden, MD
Pacific Hall A

9:40 AM Oral Poster 01
THE EFFECT OF TRIMOSAN® GEL ON THE RATE OF PESSARY-ASSOCIATED BACTERIAL VAGINOSIS: A MULTICENTER, RANDOMIZED, CONTROLLED TRIAL.
K. V. Meriwether^{1,2}; R. Rogers¹; R. E. Gutman²; S. Peterson³; E. Craig¹; M. Rode¹; C. Iglesia²
1. OB/GYN, Urogynecology Subdivision, University of New Mexico, Albuquerque, NM, 2. OB/GYN, Washington Hospital Center, Washington, DC, 3. School of Medicine, University of New Mexico, Albuquerque, NM

9:43 AM Oral Poster 02
LIPOSOMAL BUPIVACAINE REDUCES TOTAL OPIOID REQUIREMENTS AND THE NEED FOR IV OPIOIDS AFTER LAPAROTOMY FOR GYNECOLOGIC MALIGNANCIES
E. Kalogera; J. Bakkum-Gamez; A. Weaver; J. Lovely; W. Cliby; S. Dowdy
Mayo Clinic, Rochester, MN

9:46 AM Oral Poster 03
THE ASSOCIATION BETWEEN COLORECTAL ANAL DISTRESS, DEPRESSION AND ANXIETY
J. J. Navas¹; S. Amaya²; T. Yazdany¹
1. FPMRS, Harbor-UCLA Medical Center, Torrance, CA, 2. Los Angeles Biomedical Research Institute, Torrance, CA

9:49 AM ORAL POSTER Q & A

— **Monday, March 23, 2015** —

9:55 AM

Oral Presentation 06

PREVALENCE OF PELVIC FLOOR DISORDERS IN WOMEN WITH GYNECOLOGIC MALIGNANCIES

C. E. Bretschneider¹; K. Doll^{1,3}; J. T. Bensen³; P. A. Gehrig^{1,3}; J. M. Wu^{1,2}; E. J. Geller¹

1. Obstetrics and Gynecology, University of North Carolina, Chapel Hill, Chapel Hill, NC, 2. Center for Women's Health Research, University of North Carolina, Chapel Hill, NC, 3. Lineberger Comprehensive Cancer Center, University of North Carolina, Chapel Hill, NC

DISCUSSANT: C Bryce Bowling, MD

10:10 AM

Oral Presentation 07

THE USE OF MECHANICAL BOWEL PREPARATION IN LAPAROSCOPIC GYNECOLOGIC SURGERY: A DECISION ANALYSIS

K. L. Kantartzis¹; J. P. Shepherd²

1. University of Arizona, Tempe, AZ, 2. University of Pittsburgh, Pittsburgh, PA

DISCUSSANT: Sangeeta Mahajan, MD

10:25 AM

Video Presentation 02

SURGICAL MANAGEMENT OF VAGINAL AGGLUTINATION DUE TO LICHEN PLANUS

P. S. Fairchild; H. K. Haefner

Department of Ob/Gyn, University of Michigan, Ann Arbor, MI

DISCUSSANT: Carmen Sultana, MD

10:35 AM

Oral Poster 04

INCIDENCE OF POSTOPERATIVE DELIRIUM IN UROGYNECOLOGY SURGICAL PATIENTS

K. M. Reagan¹; D. M. O'Sullivan²; R. S. Dicks³

1. Female Pelvic Medicine and Reconstructive Surgery, Hartford Hospital, Hartford, CT, 2. Research Administration, Hartford Hospital, Hartford, CT, 3. Geriatrics, Hartford Hospital, Hartford, CT

— Monday, March 23, 2015 —

Monday

- 10:38 AM **Oral Poster 05**
POSTOPERATIVE PAIN AFTER UROGYNECOLOGIC PROCEDURES IN THE ELDERLY
R. N. Drinkwater; B. R. Henley; B. A. Parnell
 Georgia Regents University, Augusta, GA
- 10:41 AM **Oral Poster 06**
DOES PELVIC ORGAN PROLAPSE QUANTIFICATION EXAM (POPQ) D-POINT PREDICT UTEROSACRAL LIGAMENT SUSPENSION OUTCOMES?
 L. A. Richter³; A. J. Park³; J. E. Boileau¹; M. Janni¹; S. Desale²; C. Iglesia³
 1. Georgetown University School of Medicine, Washington, DC, 2. MedStar Health Research Institute, Washington, DC, 3. MedStar Washington Hospital Center, Washington, DC
- 10:44 AM **ORAL POSTER Q & A**
- 10:50 AM **KEYNOTE LECTURE**
"Is Teaching Evidence-Based Surgery Possible?"
 David Grimes, MD
 Introduced by Charles Rardin, MD
- 11:35 AM - 12:35 PM Lunch/Exhibits/Review Posters**
Exhibit Hall – Pacific Hall B
- 12:35 PM - 2:20 PM Third Scientific Session**
 Moderators: Wilma Larsen, MD and Atif Fazari, MD
Pacific Hall A
- 12:35 PM **Video Presentation 03**
PUBOVAGINAL SLING FOR STRESS URINARY INCONTINENCE USING AUTOLOGOUS FASCIA LATA
 A. Clancy¹; M. Larouche²; G. W. Cundiff²
 1. Obstetrics and Gynecology, University of Ottawa, Ottawa, ON, Canada, 2. Obstetrics and Gynecology, University of British Columbia, Vancouver, BC, Canada
- DISCUSSANT:** Brett Vassallo, MD
- 12:45 PM **SRG UPDATE – Miles Murphy, MD**

—Monday, March 23, 2015—

1:05 PM

Oral Poster 07

SACROCOLPOPEXY (ASC) AND VAGINAL NATIVE TISSUE APICAL REPAIR (VAR): A RETROSPECTIVE COMPARISON OF SUCCESS AND SERIOUS ADVERSE EVENTS (SAE) AMONG PARTICIPANTS FROM MULTIPLE RANDOMIZED TRIALS

R. G. Rogers¹; T. Nolen²; A. Weidner³; H. E. Richter⁶; J. Jelovsek⁵; S. Meikle⁴; J. Shepherd⁷; H. S. Harvie⁸; L. Brubaker⁹; S. Menefee¹⁰; D. Myers¹¹; Y. Hsu¹²; J. I. Schaffer¹³; D. Wallace²

1. Ob/Gyn, University of New Mexico Health Sciences Center, Albuquerque, NM, 2. RTI International, Research Triangle Park, NC, 3. Obstetrics and Gynecology, Duke University, Durham, NC, 4. NICHD, Bethesda, MD, 5. Obstetrics and Gynecology, Cleveland Clinic, Cleveland, OH, 6. Obstetrics and Gynecology, University of Alabama, Birmingham, AL, 7. Obstetrics and Gynecology, University of Pittsburgh, Pittsburgh, PA, 8. Obstetrics and Gynecology, University of Pennsylvania, Philadelphia, PA, 9. Stritch School of Medicine, Maywood, IL, 10. Obstetrics and Gynecology, Kaiser Permanente, San Diego, CA, 11. Obstetrics and Gynecology, Brown University, Providence, RI, 12. Obstetrics and Gynecology, University of Utah, Salt Lake City, UT, 13. Obstetrics and Gynecology, UT Southwestern, Dallas, TX

1:08 PM

Oral Poster 08

PANNICULECTOMY IN GYNECOLOGIC SURGERY: A REPORT ON OUTCOMES

R. Rasmussen, MD, MBA; M. Hopkins, MD
OBGyn, NEOMED Aultman Hospital, Louisville, OH

1:11 PM

Oral Poster 09

COMPARISON OF METHODS OF TISSUE EXTRACTION: MANUAL VERSUS POWER MORCELLATION

E. Abi khali¹; D. Opoku-Anane²; D. Harman¹; S. Fischer³; D. Robinson²; D. Marfori²; D. Moawad²

1. Obstetrics and Gynecology, George Washington University Hospital, Arlington, VA, 2. Minimally invasive gynecologic surgery department, George Washington University Hospital, Washington, DC, 3. George Washington university, Washington, DC

— **Monday, March 23, 2015** —

Monday

- 1:14 PM **ORAL POSTERS Q & A**
- 1:20 PM **TEACHING THE NEXT GENERATION PANEL DISCUSSION**
Moderator: Hal Lawrence, MD
Mark Walters, MD, Dee Fenner, MD
- 2:30 PM - 4:10 PM Videofest**
Moderators: Gena Dunivan, MD and Ernest Lockrow, MD
Pacific Hall A
- 2:30 PM **Videofest 09**
ROBOT-ASSISTED LAPAROSCOPIC PELVIC AND PARA-AORTIC LYMPH NODE DISSECTION: AN EDUCATIONAL VIDEO
S. Jorge; M. D. Truong; W. M. Burke
Obstetrics and Gynecology, Columbia University Medical Center, New York, NY
- 2:37 PM **Videofest 10**
URETERAL ENDOMETRIOSIS: STRATEGIES FOR THE DIFFICULT URETEROLYSIS
A. Ecker; S. Mansuria; T. Lee
OB/Gyn, Magee Womens Hospital UPMC, Pittsburgh, PA
- 2:44 PM **Videofest 11**
LAPAROSCOPIC VAGINAL CUFF CLOSURE: A SIMULATION TRAINING MODEL
T. M. Muffy¹; E. Tunitsky²
1. Female Pelvic Medicine and Reconstructive Surgery, University of Colorado Anschutz Medical Campus, Englewood, CO, 2. Female Pelvic Medicine and Reconstructive Surgery, Hartford Hospital, Hartford, CT
- 2:50 PM **Q & A**
- 2:55 PM **Videofest 12**
LAPAROSCOPIC RETROPUBIC MESH EXCISION
J. Shaw; C. Rardin
Urogynecology, Brown University, Providence, RI

— **Monday, March 23, 2015** —

- 3:01 PM **Videofest 13****
**ROBOTIC APPROACH TO EXCISION OF A
RECURRENT RETROPUBIC SLING EROSION INTO
THE BLADDER**
J. Li; R. LeFevre
Beth Israel Deaconess Medical Center, Boston, MA
- 3:08 PM **Q & A**
- 3:13 PM **Videofest 14**
**LAPAROSCOPIC SUPRACERVICAL
HYSTERECTOMY WITH SACROCERVICOPEXY:
COLPOTOMY FOR UTERINE REMOVAL WITHOUT
MORCELLATION**
M. Loring^{2,1}; P. L. Rosenblatt²
1. Minimally-Invasive Gynecologic Surgery, Newton-
Wellesley Hospital, Newton, MA, 2. Female Pelvic
Medicine and Reconstructive Surgery, Mount Auburn
Hospital, Cambridge, MA
- 3:20 PM **Videofest 15**
**REMOVAL OF TWO MIDURETHRAL SLINGS, REPAIR
OF URETHRAL DIVERTICULUM, AND PLACEMENT
OF A RECTUS FASCIA SLING**
S. Raman; C. Rardin
Department of Obstetrics and Gynecology, Division of
Urogynecology, Warren Alpert Medical School of Brown
University, Providence, RI
- 3:27 PM **Q & A**
- 3:32 PM **Videofest 16**
**PRINCIPLES AND TECHNIQUES OF LAPAROSCOPIC
DISSECTION**
C. R. King²; T. Lee¹
1. OB/GYN, Magee-Womens Hospital of UPMC,
Pittsburgh, PA, 2. OB/GYN, University of Wisconsin-
Madison, Madison, WI

****Member Candidate Presentation**

— **Monday, March 23, 2015** —

Monday

- 3:39 PM **Videofest 17**
HYSTEROSCOPIC MYOMECTOMY OF MULTIPLE SUBMUCOSAL FIBROIDS WITH MYOSURE TISSUE REMOVAL SYSTEM
N. Mahnert; C. Lim; B. Skinner; E. Quint; S. As-Sanie
University of Michigan, Ann Arbor, MI
- 3:46 PM **Q & A**
- 3:51 PM **Videofest 18**
FACILITATION OF VESICO-VAGINAL FISTULA REPAIR USING A WHISTLE TIP URETERAL STENT
O. F. Duenas; P. Kandadai; M. K. Flynn
Obstetrics and Gynecology, University of Massachusetts, Worcester, MA
- 3:58 PM **Videofest 19**
MISPLACED HYSTEROSCOPIC STERILIZATION MIRCO-INSERT IN THE PERITONEAL CAVITY: A CORPUS ALIENUM
S. Jiang²; Q. Bui²; E. Lewinter²; T. M. Muffly¹
1. Female Pelvic Medicine and Reconstructive Surgery, University of Colorado Anschutz Medical Campus, Englewood, CO, 2. School of Medicine, University of Colorado, Aurora, CO
- 4:05 PM **Q & A**
- 2:30 PM - 6:30 PM **FPRN™ Meeting**
Asia 5
- 6:45 PM - 7:15 PM **Awards Ceremony**
Pacific Hall A
- 7:15 PM - 8:30 PM **President's Reception**
Pacific Hall B



Mojito Night in the Caribbean!

Tuesday, March 24, 2015 - 7:00 PM - 8:30 PM

Crescent Terrace - Walt Disney World Dolphin

SHARE a good time, cocktails and some hors d'oeuvres to support the SGS mission.

A portion of each ticket sold to this event will go towards the SGS Mission to Advance Research and Education.

Golf and Tennis Tournament Winners will be announced during the reception.

Tickets still available at the SGS Registration Desk in Atlantic Hallway Foyer.

Tuesday, March 24

— Tuesday, March 24, 2015 —

6:00 AM – 1:30 PM **Registration**
Atlantic Hall Foyer

6:30 AM – 7:30 AM **Poster Viewing/Speaker Ready/Video Café with Continental Breakfast**
Pacific Hall C

6:30 AM – 7:30 AM **Academic Roundtables - Back of Pacific Hall C**

1. Tricks for in-bag and other kinds of morcellation – Arnold Advincula, MD
2. Which apical suspension should I choose? – Mark Walters, MD
3. Standard and innovative treatments for fecal incontinence – Gena Dunivan, MD
4. Management of the geriatric patient – Elizabeth Erekson, MD
5. Single site surgery: indications, procedures and techniques – Elliot Greenberg, MD
6. Update on gynecologic coding and billing: Preparing for ICD10 – Mitch Schuster, MD
7. Testing modalities for anorectal disorders – Dee Fenner, MD
8. Robotic Surgery – tips on efficiency and team science – Oz Harmanli, MD
9. Multimodal pain management for the perioperative patient – Kio Nihira, MD
10. Tips and tricks for dealing with mesh erosions – C. Bryce Bowling, MD
11. Cost-effectiveness analysis modeling – Jonathan Shepherd, MD
12. Endometriosis surgery – ablation versus excision and which tools to use – Deirdre Lum, MD
13. Severe endometriosis-management cul de sac, bowel, bladder, ureter – Grace Janik, MD
14. Surviving healthcare transformation: if you're not sitting at the table, you're on the menu – Drew Cassidenti, MD
15. Natural Orifice Sacralcolpopexy – Charles Hanes, MD

7:30 AM - 9:15 AM **Fourth Scientific Session**
Moderators: Rachel Pauls, MD and Alfred Bent, MD
Pacific Hall A

— **Tuesday, March 24, 2015** —

7:30 AM

Oral Presentation 08

**ANATOMIC VARIATIONS OF THE PUDENDAL NERVE
WITHIN THE PELVIS AND PUDENDAL CANAL WITH
CLINICAL APPLICATIONS**

P. A. Maldonado; A. D. Garcia; K. Chin; M. Corton
OB/GYN, UT Southwestern Medical Center, Dallas, TX

DISCUSSANT: Kimberly Kenton, MD

7:45 AM

Oral Presentation 09

**CRITICAL ANATOMY IN RELATION TO THE SACRAL
SUTURE; A POSTOPERATIVE IMAGING STUDY
FOLLOWING ROBOTIC SACROCOLPOPEXY**

C. C. Crisp; C. V. Herfel; R. N. Pauls; L. B. Westermann;
S. D. Kleeman

Good Samaritan Hospital, Cincinnati, OH

DISCUSSANT: Charles Nager, MD

8:00 AM

Oral Presentation 10

**PROXIMITY OF UTEROSACRAL LIGAMENT
SUSPENSION SUTURES AND SACRAL NERVE
ROOTS TO PELVIC ANATOMIC LANDMARKS**

P. A. Maldonado; M. A. Stuparich; D. McIntire; C. Y. Wai
OB/GYN, UT Southwestern Medical Center, Dallas, TX

DISCUSSANT: Gena Dunivan, MD

8:15 AM

Oral Presentation 11

**PROSPECTIVE RANDOMIZED TRIAL OF CESAREAN
DELIVERY VERSUS VAGINAL DELIVERY FOR
EFFECTS ON THE PELVIC FLOOR IN SQUIRREL
MONKEYS**

F. Lindo¹; E. S. Carr¹; M. Reyes¹; J. M. Gendron²; J.
Ruiz³; V. L. Parks³; W. Larsen¹; T. Kuehl^{1,4}

1. OB/GYN-FPMRS, BaylorScott & White Healthcare,
and Texas A&M Health Science Center College of
Medicine, Temple, TX, 2. Radiology, BaylorScott and
White Healthcare, and Texas A&M Health Science
Center College of Medicine, Temple, TX, 3. Department
of Veterinary Sciences, Michale E Keeling Center for
Comparative Medicine and Research, The University of
Texas MD Anderson Cancer Center, Bastrop, Texas,
Bastrop, TX, 4. Molecular & Cellular Medicine,
BaylorScott and White Healthcare, and Texas A&M
Health Science Center College of Medicine, Temple, TX

DISCUSSANT: Marlene Corton, MD

— **Tuesday, March 24, 2015** —

8:30 AM

Oral Presentation 12

**TIME TRENDS IN POST-HYSTERECTOMY
VESICOVAGINAL FISTULA AND LOWER URINARY
TRACT INJURY**

R. A. Adam¹; A. Graves²; S. Ni³; M. McPheeters⁴

1. Obstetrics and Gynecology, Vanderbilt University Medical Center, Nashville, TN, 2. Department of Urologic Surgery, Vanderbilt University Medical Center, Nashville, TN, 3. Institute for Medicine and Public Health, Vanderbilt University Medical Center, Nashville, TN, 4. Health Policy, Vanderbilt University Medical Center, Nashville, TN

DISCUSSANT: Blair Washington, MD

8:45 AM

DEBATE - POWER MORCELLATION

Moderator: Cheryl Iglesia, MD

PRO: *The Ifs, Whens and Hows* - Drs. Andrew Sokol and Jubilee Brown

CON: *The Why Nots and Alternatives* - Drs. Eric Sokol and Carl Zimmerman

9:15 AM - 9:45 AM

Refreshments/Exhibits/View Posters

Exhibit Hall – Pacific Hall B

9:45 AM - 11:10 AM

Fifth Scientific Session

Moderators: John Gebhart, MD and Amy O'Boyle, MD
Pacific Hall A

9:45 AM

Video Presentation 04

**ROBOTIC-ASSISTED LAPAROSCOPIC
INTRAVESICAL RESECTION OF A POLYPROPYLENE
RETROPUBIC MID-URETHRAL SLING**

M. Ellerkmann¹; D. Goldstein²; K. Hoskey³

1. Center for Urogynecology, Mercy Medical Center, Baltimore, MD, 2. Urology, Greater Baltimore Medical Center, Towson, MD, 3. Urogynecology, Anne Arundel Medical Center, Annapolis, MD

DISCUSSANT: Megan Schimpf, MD

Tuesday

— Tuesday, March 24, 2015 —

9:55 AM

Oral Presentation 13

ROBOTIC SURGICAL SIMULATION VERSUS TRADITIONAL DIDACTICS FOR SURGICAL TRAINING: A RANDOMIZED CONTROLLED TRIAL

M. D. Truong^{1,2}; A. Tanaka²; C. Graddy²; K. Simpson^{1,2};
M. Perez²; A. P. Advincula^{1,2}; R. D. Smith²

1. Obstetrics and Gynecology, Columbia University
Medical Center, New York, NY, 2. Research Department,
Nicholson Center, Celebration Health at Florida Hospital,
Celebration, FL

DISCUSSANT: Rebecca Rogers, MD

10:10 AM

Oral Presentation 14

RANDOMIZED TRIAL OF CADAVER LABORATORY VS PELVIC CLAY MODEL FOR RESIDENT ANATOMY INSTRUCTION

M. M. Mamik; C. Ascher-Walsh; A. D. Garely; J. A. Fantl;
M. Brodman

Icahn School of Medicine at Mount Sinai, New York, NY

DISCUSSANT: Mikio A. Nihira, MD

10:25 AM

TELINDE LECTURE

"Teaching Medicine and Surgery to Sesame Street Graduates"

Sandra A. Carson, MD

Introduction by SGS President Stephen Metz, MD

11:10 AM - 12:10 PM Lunch/Exhibits/View Posters

Pacific Hall B

12:10 PM - 1:10 PM Sixth Scientific Session

Moderators: Lennox Hoyte, MD and Vincent Lucente, MD

12:10 PM

Video Presentation 05A

BALLOON-ASSISTED LAPAROSCOPIC SACROCOLPOPEXY - A TIPS & TRICKS VIDEO

D. D. Gruber¹; H. M. Barbier¹; C. Jones¹; H. Gonzalez¹; J.
Welgoss²

1. Female Pelvic Medicine & Reconstructive Surgery,
Walter Reed National Military Medical Center, Potomac,
MD, 2. Obstetrics/Gynecology, Inova Fairfax, Fairfax, VA

— Tuesday, March 24, 2015 —

- 12:15 PM **Video Presentation 05B**
VAGINAL SALPINGECTOMY: ROUND LIGAMENT AND MESOSALPINX TECHNIQUE
N. Bassiouni¹; R. Kho²
1. Gynecologic Surgery, Mayo Clinic in Arizona, Phoenix, AZ, 2. Urogynecology, Columbia University Medical Center, New York, NY
- 12:20 PM **PRESIDENTIAL ADDRESS**
Stephen Metz, MD
- 12:40 PM **Oral Poster 10**
SKILL, DUTY, AND ADAPTABILITY: HOW EXPERT GYNECOLOGIC SURGEONS CONCEPTUALIZE EXPERTISE
M. A. Nihira¹; E. LeClaire²; P. Hardre³
1. OB/GYN, Univ. Oklahoma, Oklahoma City, OK, 2. OB/GYN, University of Kansas, Wichita, KS, 3. College of Education, University of Oklahoma, Norman, OK
- 12:43 PM **Oral Poster 11**
EFFECT OF ANESTHESIA TYPE ON PERIOPERATIVE OUTCOMES FOR MIDURETHRAL SLING
B. Davé¹; C. Jaber³; A. Leader-Cramer¹; N. Higgins²; M. Mueller¹; L. L. Johnson¹; C. Lewicky-Gaupp¹; K. Kenton¹
1. Female Pelvic Medicine and Reconstructive Surgery, Northwestern University Feinberg School of Medicine, Chicago, IL, 2. Anesthesiology, Northwestern University Feinberg School of Medicine, Chicago, IL, 3. Loyola University Chicago Stritch School of Medicine, Chicago, IL
- 12:46 PM **Oral Poster 12**
A SIMPLE METHOD FOR POSTOPERATIVE VOIDING ASSESSMENT FOLLOWING UROGYNECOLOGIC SURGERY
N. Dolgun; K. Jones; A. Rauktys; P. Behrens; O. Harmanli
Obstetrics and Gynecology, Tufts University School of Medicine Baystate Medical Center, Obstetrics and Gynecology, , Massachusetts, Springfield, MA
- 12:49 PM **ORAL POSTERS Q & A**

— ***Tuesday, March 24, 2015*** —

- 12:55 PM **Oral Presentation 15**
INDICATIONS AND RISK FACTORS FOR
MIDURETHRAL SLING REVISION
C. A. Unger; A. E. Rizzo; B. Ridgeway
OBGYN, Cleveland Clinic, Cleveland, OH
- DISCUSSANT:** Joseph Schaffer, MD
- 1:10 PM - 1:40 PM **SGS Business Meeting (Members Only)**
Pacific Hall A
- 1:45 PM **Golf Tournament**
Bus Leaving from Covered Convention Entrance Across
from Europe 2
- 2:00 PM **Paddleboarding in Winter Park**
Bus Leaving from Covered Convention Entrance Across
from Europe 2
- 2:30 PM **Tennis Tournament**
Meet at Tennis Courts
- 7:00 PM - 8:30 PM **Mojito Night in the Caribbean (Ticketed Event)**
Crescent Terrace

Wednesday, March 25

— **Wednesday, March 25, 2015** —

6:00 AM – 12:00 PM Registration

Atlantic Hall Foyer

6:30 AM - 7:30 AM Poster Viewing/Video Café with Continental Breakfast

Pacific Hall C

7:30 AM - 9:30 AM Seventh Scientific Session

Moderators: Jeffrey Cornella, MD and Andrew Cassidenti, MD
Pacific Hall A

7:30 AM

Video Presentation 06

EXCISION OF A COMPLETE LONGITUDINAL VAGINAL, CERVICAL, AND UTERINE SEPTUM

J. Schmitt; M. Hopkins; J. Gebhart

Gynecologic Surgery, Mayo Clinic, Rochester, MN

DISCUSSANT: Michael P. Diamond, MD

7:40 AM

Oral Presentation 16

OPERATIVE TIME ABOVE 240 MINUTES DURING LAPAROSCOPIC MYOMECTOMY IS ASSOCIATED WITH INCREASED 30-DAY COMPLICATIONS AND BLOOD TRANSFUSION

T. Catanzarite¹; B. Vieira²; K. Shih²; J. Y. Kim²; M. Milad¹

1. Department of OB/GYN, Northwestern University Feinberg School of Medicine, Chicago, IL, 2. Department of Surgery, Northwestern University Feinberg School of Medicine, Chicago, IL

DISCUSSANT: Tyler Muffly, MD

7:55 AM

Oral Presentation 17

FACTORS ASSOCIATED WITH PROPHYLACTIC BILATERAL SALPINGO-OOPHORECTOMY IN WOMEN UNDER 50 YEARS OF AGE

N. Karp; D. Fenner; D. M. Morgan

Female Pelvic Medicine and Reconstructive Surgery, University of Michigan, Ann Arbor, MI

DISCUSSANT: Eman Elkadry, MD

— **Wednesday, March 25, 2015** —

- 8:10 AM **Oral Poster 13**
NATIONAL TRENDS OF ADNEXAL SURGERY AT THE TIME OF HYSTERECTOMY FOR BENIGN INDICATION, UNITED STATES 1998-2011
E. Mikhail¹; J. Salemi²; M. Mogos³; S. Hart¹; H. Salihu²; A. Imudia¹
1. Obstetrics and Gynecology, University of South Florida, Tampa, FL, 2. University of South Florida, Tampa, FL, 3. Indiana University, Indianapolis, IN
- 8:13 AM **Oral Poster 14**
TRENDS IN URODYNAMICS STUDIES IN A MANAGED CARE POPULATION: 2010-2011 VERSUS 2013-2014
Q. K. Lippmann¹; G. Diwadkar¹; H. Zhou²; S. Menefee¹
1. FPMRS, UCSD/Kaiser Permanente, Del Mar, CA, 2. Biostatistics, Kaiser Permanente, Pasadena, CA
- 8:16 AM **Oral Poster 15**
SYMPTOM RELIEF AND RETREATMENT AFTER VAGINAL, OPEN ABDOMINAL, AND ROBOTIC SURGERIES FOR APICAL VAGINAL VAULT PROLAPSE
M. Anand¹; A. Weaver²; K. Fruth²; E. Trabuco¹; J. Gebhart¹
1. Department of Obstetrics and Gynecology, Division of Gynecologic Surgery, Mayo Clinic, Rochester, MN, 2. Department of Biomedical Statistics and Informatics, Mayo Clinic, Rochester, MN
- 8:19 AM **ORAL POSTERS Q & A**
- 8:25 AM **Oral Presentation 18**
ASSESSING THE LEARNING CURVE OF ROBOTIC SACROCOLPOPEXY
B. J. Linder; M. Anand; A. Weaver; J. L. Woelk; C. Klingele; E. Trabuco; J. A. Occhino; J. Gebhart
Mayo Clinic, Rochester, MN
- DISCUSSANT:** Patrick Culligan, MD
- 8:40 AM **FPRN EDUCATION UPDATE – Miles Murphy, MD**

— **Wednesday, March 25, 2015** —

- 9:00 AM **Video Presentation 07**
PREVENTION, RECOGNITION, AND MANAGEMENT
OF COMPLICATIONS ASSOCIATED WITH
SACROSPINOUS COLPOPEXY
A. J. Hill¹; J. Danford²; N. Kow¹; C. W. Zimmerman²; M.
D. Walters¹
1. Center for Urogynecology and Reconstructive Pelvic
Surgery, Cleveland Clinic, Cleveland, OH, 2. Vanderbilt
University Medical Center, Nashville, TN
DISCUSSANT: Robert Gutman, MD
- 9:10 AM **Update on NCCI Decision Concerning Procedure**
Edits Affecting Vaginal Hysterectomy – Marc Toggia,
MD
- 9:25 AM **DISTINGUISHED SURGEON AWARD**
Presentation by SGS President Stephen Metz, MD
- 9:40 AM **PASSING OF THE GAVEL**
- 9:45 AM - 10:15 AM **Refreshments/View Posters/Video Café**
Pacific Hall C
- 10:15 AM - 11:40 AM **Eighth Scientific Session**
Moderators: Andrew Walter, MD and
Michael Bonidie, MD
Pacific Hall A
- 10:15 AM **Oral Presentation 19**
HEALTH RESOURCE UTILIZATION AND COSTS
DURING FIRST 90 DAYS FOLLOWING ROBOTIC
ASSISTED HYSTERECTOMY
V. Dandolu; P. Pathak
Obstetrics and Gynecology, UNSOM, Las Vegas, NV
DISCUSSANT: Emily Weber LeBrun, MD

— **Wednesday, March 25, 2015** —

10:30 AM **Oral Presentation 20**

APICAL PROCEDURES AND ANTERIOR VAGINAL PROLAPSE: PRACTICE PATTERNS IN THE UNITED STATES IN 2011

G. M. Northington¹; C. O. Hudson; D. Karp; S. A. Huber
Gynecology and Obstetrics, Emory University, Atlanta, GA

DISCUSSANT: Christine Vaccaro, MD

10:45 AM **Oral Presentation 21**

SURGICAL ASSESSMENT VALUE ENFORCEMENT: A MODEL OF INCREASING OPERATIVE EFFICIENCY AND PRODUCTIVITY

A. C. Steinberg¹; C. A. Ficara²; D. G. Norman³; M. Gilgenbach³; S. Shichman⁴
1. Ob/GYN, Division of FPMRS, Hartford Hospital, Hartford, CT, 2. Administration, Hartford Hospital, Hartford, CT, 3. Operating Room, Hartford Hospital, Hartford, CT, 4. Urology, Hartford Hospital, Hartford, CT

DISCUSSANT: Rajiv Gala, MD

11:00 AM **Oral Poster 16**

WHEN THE APEX IS CALLING, DO SURGEONS ANSWER? TRENDS IN CYSTOCELE/RECTOCELE REPAIR OVER THE LAST 30 YEARS

J. R. Stewart; J. Hamner; M. Heit
Obstetrics & Gynecology, Indiana University School of Medicine, Indianapolis, IN

11:03 AM **Oral Poster 17**

CLINICAL AND BIOCHEMICAL EVIDENCE OF NEUROGENIC INFLAMMATION IN WOMEN WITH URINARY URGENCY

U. U. Andy¹; A. Malykhina¹; H. S. Harvie¹; K. Colavita¹; K. Whitmore²; L. A. Arya¹
1. Division of Urogynecology, Dept. of OB/GYN, University of Pennsylvania, Philadelphia, PA, 2. Pelvic and Sexual Health Institute, Philadelphia, PA

11:06 AM **Oral Poster 18**

RISK FACTORS FOR LOWER URINARY TRACT INJURY AT THE TIME OF PROLAPSE AND INCONTINENCE REPAIR SURGERIES: A MULTI-CENTERED STUDY

S. D. Pickett¹; P. A. Maldonado²; K. V. Meriwether³; C. M. Kunkle⁴; A. M. Wyman⁵; M. A. Griffin⁶; L. A. Richter⁷; S. Raman⁸; J. R. Price⁹; J. S. Joyce¹⁰; M. Mueller¹¹; D. O'Leary¹; L. Lowenstein¹²
1. Obstetrics and Gynecology- FPMRS, University of Oklahoma

— **Wednesday, March 25, 2015** —

Health Sciences Center, Oklahoma City, OK, 2. Obstetrics and Gynecology- FPMRS, UT Southwestern Medical Center, Dallas, TX, 3. Obstetrics and Gynecology- FPMRS, The University of New Mexico, Albuquerque, NM, 4. Obstetrics and Gynecology- FPMRS, Johns Hopkins, Baltimore, MD, 5. Obstetrics and Gynecology- FPMRS, University of South Florida, Tampa, FL, 6. Obstetrics and Gynecology- FPMRS, Henry Ford Hospital, Detroit, MI, 7. Urology- FPMRS, MedStar Washington Hospital Center, Washington, DC, 8. Obstetrics and Gynecology- FPMRS, Brown University- Women and Infants Hospital, Providence, RI, 9. Obstetrics and Gynecology- FPMRS, Oregon Health and Science Center, Portland, OR, 10. Obstetrics and Gynecology- FPMRS, Scott and White, Temple, TX, 11. Obstetrics and Gynecology- FPMRS, Northwestern University, Chicago, IL, 12. Obstetrics and Gynecology- FPMRS, Rambam Health Care Campus, Haifa, Israel

11:09 AM **ORAL POSTERS Q & A**

11:15 AM **Video Presentation 08**

RECTOVAGINAL FISTULA REPAIR USING A GRACILIS MUSCLE FLAP

E. D. Hokenstad¹; Z. S. Hammoudeh²; N. V. Tran²; H. K. Chua³; J. A. Occhino¹

1. Obstetrics and Gynecology, Mayo Clinic, Rochester, MN, 2. Plastic and Reconstructive Surgery, Mayo Clinic, Rochester, MN, 3. Colon and Rectal Surgery, Mayo Clinic, Rochester, MN

DISCUSSANT: Sesh Kasturi, MD

11:25 AM **Oral Poster 19**

TIMING OF RETURN TO INTERCOURSE AFTER OBSTETRIC ANAL SPHINCTER INJURIES: RESULTS FROM THE FORCAST TRIAL (FOR OPTIMAL RECOVERY: CARE AFTER SEVERE TEARS)

A. Leader-Cramer¹; K. Kenton¹; B. Dave¹; D. Gossett²; L. L. Johnson¹; M. Mueller¹; C. Lewicky-Gaupp¹

1. Female Pelvic Medicine and Reconstructive Surgery, Northwestern University, Chicago, IL, 2. Obstetrics and Gynecology, Northwestern University, Chicago, IL

— **Wednesday, March 25, 2015** —

11:28 AM Oral Poster 20

**DE NOVO DYSPAREUNIA AND SEXUAL FUNCTION
ASSESSMENT USING TWO SEXUAL QUESTIONNAIRES**

K. R. Smithling²; D. D. Antosh¹; E. Tefera³; C. Iglesia²

1. Division of Urogynecology, Dept of ObGyn, Houston Methodist Hospital, Houston, TX, 2. Dept of Obstetrics and Gynecology, Section of FPRMS, MedStar Washington Hospital Center and MedStar Georgetown University Hospital, Washington, DC, 3. Department of Biostatistics and Bioinformatics, MedStar Health Research Institute, Washington, DC

11:31 AM Oral Poster 21

POSTOPERATIVE APPOINTMENTS; WHICH ONES COUNT?

M. Mueller¹; D. Elborno²; B. Dave¹; A. Leader-Cramer¹; C. Lewicky-Gaupp¹; L. L. Johnson¹; K. Kenton¹

1. OB/GYN, Northwestern University, Chicago, IL, 2. Loyola University Chicago, Stritch School of Medicine, Maywood, IL

11:34 AM ORAL POSTERS Q & A

11:40 AM ADJOURN

— Video Café —

Available Throughout The Meeting
Pacific Hall C

Video Café 20

HYSTEROSCOPIC MANAGMENT OF A DOUBLE UTERINE PATHOLOGY

A. Abdelaziz¹; I. Fahmi¹; O. Zaghmout¹; S. Joseph²; M. Abuzeid¹

1. OBGYN, Hurley Medical Center- Michigan State University, Flint, MI, 2. IVF Michigan, Rochester, MI

Video Café 21

A NOVEL APPROACH TO OVERCOMING CERVICAL STENOSIS AND FALSE PASSAGES

A. A. Adajar, M.D.¹; A. J. Rivera, M.D.²

1. Illinois Institute of Gynecology and Advanced Pelvic Surgery, Glenview, IL, 2. Misha Media Photography, Hoffman Estates, IL

Video Café 22

A TECHNIQUE FOR VASCULAR CONTROL DURING ROBOTIC MYOMECTOMY

L. Clark¹; G. Menderes¹; M. Azodj^{1,2}

1. Ob-GYN, Bridgeport Hospital/Yale New Haven Health System, Bridgeport, CT, 2. Ob-Gyn, Yale University, New Haven, CT

Video Café 23

A STANDARDIZED APPROACH TO THE EXCISION OF MIDURETHRAL SLINGS

D. R. Ellington; I. S. Meyer; A. M. Parden; H. E. Richter

Division of Urogynecology and Pelvic Reconstructive Surgery, University of Alabama at Birmingham, Birmingham, AL

Video Café 24

LAPAROSCOPIC CYSTECTOMY OF LARGE, BILATERAL OVARIAN DERMoids

E. J. Cooney; G. E. Makai; N. R. Patel

Obstetrics and Gynecology, Christiana Care Hospital, Newark, DE

Video Café 25

RECTOVAGINAL FISTULA REPAIR

A. Fazari; D. Mohammed

Faculty of Medicine, University of Medical Science and Technology, Khartoum, Sudan

— Video Café —

Video Café 26

ROBOTIC HYSTERECTOMY FOR A LARGE MYOMATOUS UTERUS

G. Menderes^{2,1}; E. Baltes²; D. Silasi^{1,2}

1. Obstetrics, Gynecology and Reproductive Sciences, Yale University School of Medicine, West Haven, CT, 2. Obstetrics and Gynecology, Yale New Haven Health/ Bridgeport Hospital, Bridgeport, CT

Video Café 27

RECTAL ENDOMETRIOSIS RESECTION: REPAIR WITH BARBED SUTURE

A. Ecker; T. Lee

OB/Gyn, Magee Womens Hospital UPMC, Pittsburgh, PA

Video Café 28

SODIUM FLUORESCEIN AS AN ALTERNATIVE TO INDIGO CARMINE™ DURING INTRAOPERATIVE CYSTOSCOPY

P. J. Doyle; E. Duecy; R. Wood

University of Rochester, Rochester, NY

Video Café 29

ROBOTIC RESECTION OF INTRAVESICAL POLYPROPYLENE MESH FOLLOWING TENSION FREE TAPE PROCEDURE

C. Russman, DO; B. Lingenfelter, DO; J. Long, MD; C. Pugh, DO

Obstetrics & Gynecology, Reading Health System, Reading, PA

Video Café 30

ROBOTIC ASSISTED TOTAL LAPAROSCOPIC HYSTERECTOMY: UTERINE DIDELPHYS

T. P. Hoke¹; M. E. Borowsky²; N. Patel¹

1. Obstetrics and Gynecology, Christiana Care Health System, Newark, DE, 2. Gynecologic Oncology, Christiana Care Health System, Newark, DE

Video Café 31

HERLYN WERNER WUNDERLICH SYNDROME- AN UNUSAL PRESENTATION

R. Raju; D. Bolonduro; O. Abuzeid; D. Ahsraf; D. Abuzeid

Obstetrics and Gynecology, Hurley Medical Center, Grand Blanc, MI

Video Café 32

URETERAL REIMPLANTATION THROUGH THE USE OF A RUNNING STITCH

N. Rindos; T. Lee

Obstetrics and Gynecology, Magee Womens Hospital, Pittsburgh, PA

— *Video Café* —

Video Café 33

DEEP ENDOMETRIOSIS: SURGICAL APPROACH AND ANATOMIC LANDMARKS

L. Fernandes; L. Myung; M. Abrao

University of São Paulo, São Paulo, Brazil

Video Café 34

LAPAROSCOPIC MODIFIED RICHARDSON ANGLE INSEAM VAGINAL CUFF CLOSURE

B. Schlafstein

1. Gyn/UroGyn, MCG@GRU, Savannah, GA, 2. Gyn / UroGyn, St. Joseph's / Candler Hospitals, Savannah, GA

— *Non-Oral Posters* —

Available Throughout The Meeting
Pacific Hall C

Non-Oral Poster 22

THE ASSOCIATION OF ROUTINE HOSPITAL RISK ASSESSMENT SCALES AND POSTOPERATIVE MORBIDITY FOLLOWING UROGYNECOLOGIC SURGERY

C. E. Bretschneider¹; M. L. Nieto¹; E. J. Geller¹; J. M. Wu^{1,2}

1. Obstetrics and Gynecology, University of North Carolina, Chapel Hill, Carrboro, NC, 2. Center for Women's Health Research, University of North Carolina, Chapel Hill, NC

Non-Oral Poster 23

IMPACT OF INDIVIDUAL SURGEON VOLUME ON HYSTERECTOMY COSTS

J. P. Shepherd; K. L. Kantartzis; T. Lee; M. J. Bonidie

Obstetrics, Gynecology and Reproductive Sciences, University of Pittsburgh, Pittsburgh, PA

Non-Oral Poster 24

OUTCOMES OF VAGINAL CUFF REPAIR USING 0-VICRYL OR 0-VLOC™ SUTURE AFTER A ROBOTIC-ASSISTED TOTAL LAPAROSCOPIC HYSTERECTOMY

E. M. Schrop¹; C. Nkemeh³; S. Lababidi³; T. Mendise^{1,2}; E. Ferris^{1,2}; M. L. McCarroll^{1,2}; G. Roulette^{1,2}

1. Obstetrics and Gynecology, Summa Health System, Akron, OH, 2. obstetrics and Gynecology, Northeast Ohio Medical University, Rootstown, OH, 3. College of Medicine, Northeast Ohio Medical University, Rootstown, OH

Non-Oral Poster 25

THE LEARNING CURVE OF A ROBOTIC-ASSISTED TOTAL LAPAROSCOPIC HYSTERECTOMY: A RETROSPECTIVE EVALUATION AND CUMULATIVE SUMMATION ANALYSIS

E. M. Schrop¹; C. Nkemeh³; S. Lababidi³; T. Mendise^{1,2}; E. Ferris^{1,2}; M. L. McCarroll^{1,2}; G. Roulette^{1,2}

1. Obstetrics and Gynecology, Summa Health System, Akron, OH, 2. Obstetrics and Gynecology, Northeast Ohio Medical University, Rootstown, OH, 3. College of Medicine, Northeast Ohio Medical University, Rootstown, OH

Non-Oral Poster 26

SURGEON FACTORS AND LOWER URINARY TRACT INJURY AT THE TIME OF HYSTERECTOMY

C. M. Carter^{1,2}; D. M. Gidali^{1,2}; K. W. Prather³; L. A. Richter⁴; C. B. Iglesia^{4,3}; A. J. Park^{4,3}

— *Non-Oral Posters* —

1. Obstetrics & Gynecology, MedStar Washington Hospital Center, Washington, DC, 2. Obstetrics & Gynecology, MedStar Georgetown University Hospital, Washington, DC, 3. Georgetown University School of Medicine, Washington, DC, 4. Female Pelvic Medicine and Reconstructive Surgery, MedStar Washington Hospital Center, Washington, DC

Non-Oral Poster 27

FACTORS ASSOCIATED WITH CATASTROPHIZING IN WOMEN WITH URINARY URGENCY

D. Lee¹; L. A. Arya¹; H. S. Harvie²; U. Andy¹

1. Hospital of the University of Pennsylvania, Philadelphia, PA, 2. Pennsylvania Hospital, Philadelphia, PA

Non-Oral Poster 28

STANDARDIZATION OF LAPAROSCOPIC OPERATIVE REPORTS

R. J. Pope¹; M. A. Bedaiwy²; A. Y. Hefnawy¹; K. Zanotti³

1. Ob/Gyn, MacDonald Women's Hospital; Case Western Reserve University Medical Center, Cleveland, OH, 2. Reproductive Endocrinology and Infertility, University of British Columbia Women's Hospital, Vancouver, BC, Canada, 3. Division of Gynecology Oncology, University Hospitals Case Western Reserve University, Cleveland, OH

Non-Oral Poster 29

THE MODIFIED EQUILIBRIUM PRESSURE POINT THEORY OF STRESS URINARY INCONTINENCE

R. F. Flora

Obstetrics and Gynecology, Providence Hospital and Medical Center, Southfield, MI

Non-Oral Poster 30

10 YEARS FOLLOW-UP AFTER TVT-O PROCEDURE

T. Aigmueller; D. Ulrich; M. Klambauer; K. Tamussino

University Department of Obstetrics and Gynecology, Medical University of Graz, Graz, Austria

Non-Oral Poster 31

THE USE OF MATRISTEM MATRIX AS A BIOLOGIC GRAFT IN THE TREATMENT OF VAGINAL WALL PROLAPSE

T. S. Dunn, MD; J. Luong, DO; S. Mancini Altenberg, DO

OB/Gynecology, Rocky Vista University of Osteopathic Medicine, Denver, CO

— Non-Oral Posters —

Non-Oral Poster 32

DEVELOPING AN OBJECTIVE STRUCTURED ASSESSMENT TOOL FOR LAPAROSCOPIC SUTURING

O. H. Chang; A. Merport Modest; L. King; H. Hur
Obstetrics and Gynecology, Beth Israel Deaconess Medical Center, Boston, MA

Non-Oral Poster 33

THE EFFECT OF SURGICAL START TIME ON OPERATING ROOM TIME AND PERIOPERATIVE ADVERSE EVENTS IN PATIENTS UNDERGOING MINIMALLY INVASIVE SACROCOLPOPEXY

K. Jallad; C. A. Unger; B. Ridgeway; M. D. Barber
Cleveland Clinic Foundation, Cleveland, OH

Non-Oral Poster 34

TO OPERATE OR NOT TO OPERATE BEFORE IVF TREATMENT IN WOMEN WITH ENDOMETRIOSIS?

L. M. Ribeiro Pereira^{2,1}; J. P. Junqueira Caetano²; A. L. Menezes Campos²; M. C. França Ferreira¹; M. M. Carneiro¹

1. Obstetrics and Gynecology, Universidade Federal de Minas Gerais, Belo Horizonte, Brazil, 2. Pró-criar Reproductive Medicine Center, Belo Horizonte, Brazil

Non-Oral Poster 35

RETROSPECTIVE STUDY ON OUTCOMES AFTER MIDURETHRAL SLING (MUS) REVISION FOR PERSISTENT LOWER URINARY TRACT SYMPTOMS: WHAT CAN WE EXPECT TO RESOLVE?

A. Reyes; A. Ramaseshan; C. Medina
Jackson Memorial Hospital/University of Miami, Miami, FL

Non-Oral Poster 36

ANATOMIC COURSE OF THE URETER IN RELATION TO VERTEBRAL AND VASCULAR LANDMARKS ON COMPUTED TOMOGRAPHY

C. Ripperda¹; A. D. Garcia¹; K. Singh²; J. I. Schaffer¹; C. Y. Wai¹

1. Obstetrics and Gynecology, University of Texas Southwestern Medical Center, Dallas, TX, 2. Radiology, University of Texas Southwestern Medical Center, Dallas, TX

Non-Oral Poster 37

POST-VOID RESIDUAL IS NOT RELATED TO STAGE OF PELVIC ORGAN PROLAPSE IN WOMEN PRESENTING TO AN AMBULATORY UROGYNECOLOGY CLINIC

A. Peacher-Seaney; V. Aguilar; A. B. White

— *Non-Oral Posters* —

Obstetrics and Gynecology, University of Texas Southwestern- Austin, Austin, TX

Non-Oral Poster 38

PATHOLOGY OF POWER MORCELLATION: A 12-YEAR REVIEW

M. Abernethy; J. Shim; K. Kenton

Northwestern University Feinberg School of Medicine, Chicago, IL

Non-Oral Poster 39

THE MEDICAL AND MORPHOMETRIC CHARACTERISTICS THAT CONTRIBUTE TO PULMONARY INTOLERANCE IN THE OBESE PATIENT UNDERGOING ROBOTIC PELVIC SURGERY (RPS)

A. Y. Hefnawy¹; M. A. Bedaiwy²; S. Singh¹; K. Zanotti¹

1. ObGyn, University Case Medical Center, Cleveland, OH, 2. Division of Reproductive Endocrinology, BC Women's Hospital & Health Centre, Vancouver, BC, Canada

Non-Oral Poster 40

GENE EXPRESSION MARKERS OF IMPAIRED WOUND HEALING IN PATIENTS WITH PAIN AFTER VAGINAL MESH

L. A. Yurteri-Kaplan¹; D. Y. Jo²; J. W. Shupp²; L. T. Moffatt²; R. T. Ortiz²; M. Diamond³; C. Iglesia¹

1. Section of Female Pelvic Medicine and Reconstructive Surgery, MedStar Washington Hospital Center / Georgetown University School of Medicine, Washington, DC, 2. The Burn Center, Department of Surgery, MedStar Washington Hospital Center, Washington, DC, 3. Obstetrics and Gynecology, Georgia Regent University, Augusta, GA

Non-Oral Poster 41

ENDOMETRIOSIS AND THE APPENDIX: IS INCIDENCE RELATED TO PATHOLOGIC ANALYSIS?

G. J. Harkins; A. S. Benton; K. Riley; T. Deimling

Penn State Hershey Medical Center, Hershey, PA

Non-Oral Poster 42

CREATING A SIMULATION-BASED TRAINING WORKSHOP FOR CYSTOSCOPY

D. Arunachalam; S. Wallach

UC Davis Medical Center, Sacramento, CA

Non-Oral Poster 43

RISK FACTORS FOR VAGINAL EROSION WITH PESSARY USE

N. A. Letham^{1,2}; H. D. Brazell³; D. M. O'Sullivan⁴; C. Mellen³; A. Steinberg³

— *Non-Oral Posters* —

1. Obstetrics and Gynecology, University of Connecticut, Farmington, CT, 2. Women's Health, Hartford Hospital, Hartford, CT, 3. Urogynecology, Hartford Hospital, Hartford, CT, 4. Research Administration, Hartford Hospital, Hartford, CT

Non-Oral Poster 44

PERINEORRHAPHY: COMMONLY PERFORMED YET POORLY UNDERSTOOD; A SURVEY OF SURGEONS

G. Kanter; P. C. Jeppson; R. Rogers; B. McGuire; G. C. Dunivan; Y. Komesu
University of New Mexico, Albuquerque, NM

Non-Oral Poster 45

THE LONG AND SHORT OF IT: ANTERIOR VAGINAL WALL LENGTH BEFORE AND AFTER ANTERIOR REPAIR

C. W. Swenson; D. M. Morgan; J. O. DeLancey
University of Michigan, Ann Arbor, MI

Non-Oral Poster 46

ACUPUNCTURE IN PREMENOPAUSAL WOMEN WITH HYPOACTIVE SEXUAL DESIRE DISORDER: A PROSPECTIVE COHORT STUDY

S. Oakley^{1,2}; J. Walther-Liu³; C. C. Crisp¹; R. N. Pauls¹

1. Female Pelvic Medicine and Reconstructive Surgery, Good Samaritan Hospital, Cincinnati, OH, 2. Division of Female Pelvic Medicine and Reconstructive Surgery, St. Elizabeth Hospitals, Fort Thomas, KY, 3. Acupuncture and Holistic Health, TriHealth, Cincinnati, OH

Non-Oral Poster 47

TITANIUM SURGICAL TACKS: ARE THEY SAFE? DO THEY WORK?

A. Shatkin-Margolis; R. Margulies; M. Merchant; O. Ramm
Kaiser Permanente - Oakland Medical Center, Oakland, CA

Non-Oral Poster 48

SUBJECTIVE OUTCOMES AFTER ROBOTIC VERSUS ABDOMINAL SACROCOLPOPEXY

C. L. Kinman^{1,2}; T. N. Garcia¹; M. E. Carley¹

1. OB/GYN, Baylor University Medical Center, Dallas, TX, 2. FPMRS, University of Louisville, Louisville, KY

Non-Oral Poster 49

INDICATIONS AND RISK FACTORS FOR CONVERSION OF ROBOTIC GYNECOLOGIC PROCEDURES

C. A. Unger; B. Ridgeway; M. Lachiewicz
OBGYN, Cleveland Clinic, Cleveland, OH

— *Non-Oral Posters* —

Non-Oral Poster 50

INCIDENCE OF VENOUS THROMBOTIC EVENTS FOLLOWING GYNECOLOGIC SURGERY

A. Li¹; T. A. Moore Simas¹; A. Merport Modest²; K. Leung¹; N. Amir¹; A. Bannon¹; H. Hur²

1. Department of Obstetrics and Gynecology, University of Massachusetts Medical Center, Worcester, MA, 2. Department of Obstetrics and Gynecology, Beth Israel Deaconess Medical Center, Boston, MA

Non-Oral Poster 51

RELATIONSHIP BETWEEN POP-Q STAGE OF PELVIC ORGAN PROLAPSE AND SURGERY PERFORMED

L. E. Giugale⁵; L. C. Skoczylas²; A. D. Althouse^{3,4}; M. F. Ackenbom¹; J. P. Shepherd¹

1. Obstetrics, Gynecology and Reproductive Sciences, Division of Urogynecology, Magee Womens Hospital of University of Pittsburgh Medical Center, Pittsburgh, PA, 2. Obstetrics and Gynecology, Division of Urogynecology, Kaiser Permanente West Los Angeles, West Los Angeles, CA, 3. Magee Womens Research Institute, Pittsburgh, PA, 4. Obstetrics, Gynecology and Reproductive Sciences, University of Pittsburgh School of Medicine, Pittsburgh, PA, 5. Obstetrics, Gynecology and Reproductive Sciences, Magee Womens Hospital of University of Pittsburgh Medical Center, Pittsburgh, PA

Non-Oral Poster 52

DISCLOSURES, CONFLICT OF INTEREST AND FUNDING ISSUES IN UROGYNECOLOGY ARTICLES - A CROSS-SECTIONAL STUDY

M. Koch^{1,2}; P. A. Riss^{1,2}; W. Umek^{1,2}; E. Hanzal^{1,2}

1. Obstetrics and Gynecology, Medical University Vienna, Vienna, Austria, 2. Karl Landsteiner Institute of Special Gynecology and Obstetrics, Vienna, Austria

Non-Oral Poster 53

NEW CERVICAL CANCER SCREENING GUIDELINES: ARE WE DOING OUR JOB?

B. Woodard; K. Baker

Obstetrics and Gynecology, Memorial Health University Medical Center, Savannah, GA

Non-Oral Poster 54

DO PATIENTS' SURGICAL GOALS VARY BASED ON THE TYPE OF PROLAPSE REPAIR SELECTED?

J. M. Miranne¹; V. Melson²; C. Iglesia¹; A. I. Sokol¹

— *Non-Oral Posters* —

1. Ob/Gyn, MedStar Washington Hospital Center/Georgetown University School of Medicine, Washington, DC, 2. Lafayette College, Easton, PA

Non-Oral Poster 55

USE OF A CARDIAC ELECTROPHYSIOLOGY LABORATORY TO MAP BLADDER ELECTRICITY IN PATIENTS WITH LOWER URINARY TRACT SYMPTOMS

R. S. Kelley³; M. D. Vardy^{1,3}; G. Simons²; H. Chen⁴; C. Ascher-Walsh³; M. Brodman³

1. Obstetrics and Gynecology, Englewood Hospital and Medical Center, Englewood, NJ, 2. Cardiology, Englewood Hospital and Medical Center, Englewood, NJ, 3. Obstetrics and Gynecology, Mount Sinai Hospital, New York, NY, 4. Cardiac Electrophysiology, Private Practice, San Pablo, CA

Non-Oral Poster 56 - WITHDRAWN

Non-Oral Poster 57

FACTORS INFLUENCING SELECTION FOR VAGINAL, OPEN ABDOMINAL, OR ROBOTIC SURGERY TO TREAT APICAL VAGINAL VAULT PROLAPSE

M. Anand¹; A. Weaver²; K. Fruth²; J. Gebhart¹

1. Department of Obstetrics and Gynecology, Division of Gynecologic Surgery, Mayo Clinic, Rochester, MN, 2. Department of Biomedical Statistics and Informatics, Mayo Clinic, Rochester, MN

Non-Oral Poster 58

ULTRASOUND EVALUATION OF THE URETHRA AND BLADDER NECK BEFORE AND AFTER TRANSURETHRAL BULKING INJECTION

C. A. Unger; M. D. Walters

OBGYN, Cleveland Clinic, Cleveland, OH

Non-Oral Poster 59

CELLULAR FIBROIDS: 13-YEAR EXPERIENCE AT A LARGE ACADEMIC INSTITUTION

J. Sassani; J. P. Shepherd; T. Lee; N. M. Donnellan

ob/gyn, UPMC Magee-Womens' Hospital, Pittsburgh, PA

Non-Oral Poster 60

CURRENT TRENDS ASSOCIATED WITH PROPHYLACTIC SALPINGECTOMY WITH OVARIAN PRESERVATION AT A LARGE TERTIARY HOSPITAL

E. J. Cooney; M. K. Hoffman

Obstetrics and Gynecology, Christiana Care Hospital, Newark, DE

— *Non-Oral Posters* —

Non-Oral Poster 61

POSTPARTUM BLADDER FUNCTION: A DESCRIPTIVE STUDY

S. Wilson¹; E. A. Hemman¹; C. M. Vaccaro²

1. OBGYN, Madigan Army Medical Center, Tacoma, WA, 2. Division of Urogynecology and Pelvic Reconstructive Surgery, Madigan Army Medical Center, Tacoma, WA

Non-Oral Poster 62

PREDICTORS OF RESOLUTION OF URGENCY URINARY INCONTINENCE (UUI) AFTER ANTI-INCONTINENCE PROCEDURES PERFORMED FOR MIXED URINARY INCONTINENCE

R. Singh¹; R. Blandon²; M. McGree³; A. Weaver³; J. A. Occhino¹; C. Klingele¹; J. Gebhart¹; E. Trabuco¹

1. Obstetrics and Gynecology, Mayo Clinic, Rochester, MN, 2. Obstetrics and Gynecology, University of Missouri, Kansas City School of Medicine, Kansas City, MO, 3. Dept of Biostatistics, Mayo Clinic, Rochester, MN

Non-Oral Poster 63

URETERAL COMPROMISE AND SUTURE EXPOSURE IN LAPAROSCOPIC VERSUS VAGINAL UTEROSACRAL LIGAMENT SUSPENSION: A RETROSPECTIVE COHORT

H. M. Barbier¹; M. Z. Smith¹; C. U. Eto²; J. Welgoss³; N. Horbach³; W. Von Pechmann³; D. D. Gruber¹

1. OB/Gyn, Walter Reed National Military Medical Center Bethesda, North Bethesda, MD, 2. OB/Gyn, George Washington University, Washington, DC, 3. OB/Gyn, Inova Fairfax Hospital, Annandale, VA

Non-Oral Poster 64

ASSOCIATIONS BETWEEN BODY MASS INDICES AND RATE OF BLADDER PERFORATION DURING MIDURETHRAL SLING PLACEMENT: A MULTI-INSTITUTIONAL REVIEW

R. James^{2,3}; D. Gomelsky⁴; D. Sheyn¹; D. Slopnik²; D. T. Mahajan¹

1. OB/GYN, Division of FPMRS, University Hospitals Case Medical Center, Cleveland, OH, 2. Urology, division of FPMRS, University Hospitals Case Medical Center, Cleveland, OH, 3. Urogynecology, Metrohealth Hospital, Cleveland, OH, 4. Urology, Louisiana State University, Shreveport, LA

Non-Oral Poster 65

MEDICAL STUDENT ROBOTIC SIMULATOR PERFORMANCE DOES NOT CORRELATE WITH THEIR USMLE SCORE

M. A. Griffin¹; H. Abed¹; M. Diaz-Insua²; H. Atiemo²; A. M. Luck¹

1. Obstetrics and Gynecology, Henry Ford Hospital, Detroit, MI, 2. Vattikuti Urology Institute, Henry Ford Hospital, Detroit, MI

— Non-Oral Posters —

Non-Oral Poster 66

VAGINAL SACRAL COLPOPEXY: A PICTORIAL EXPLANATION OF SURGICAL TECHNIQUE

C. R. Hanes

Urogynecology of Southern Alabama, Mobile, AL

Non-Oral Poster 67

ATTITUDES REGARDING LABIAL HYPERTROPHY; A SURVEY OF SGS AND NASPAG MEMBERS

L. B. Westermann¹; C. C. Crisp¹; S. Oakley¹; D. Mazloomdoost¹; S. D. Kleeman¹; J. M. Benbouajili²; R. N. Pauls¹

1. Urogynecology, TriHealth Good Samaritan Hospital, Cincinnati, OH, 2. Hatton Research Institute, TriHealth, Cincinnati, OH

Non-Oral Poster 68

LOWER URINARY TRACT INJURY AT THE TIME OF HYSTERECTOMY

C. M. Carter^{1,2}; D. M. Gidali^{1,2}; K. W. Prather³; L. A. Richter⁴; C. B. Iglesia^{4,3}; A. J. Park^{4,3}

1. Obstetrics & Gynecology, MedStar Washington Hospital Center, Washington, DC, 2. Obstetrics & Gynecology, MedStar Georgetown University Hospital, Washington, DC, 3. Georgetown University School of Medicine, Washington, DC, 4. Female Pelvic Medicine and Reconstructive Surgery, MedStar Washington Hospital Center, Washington, DC

Non-Oral Poster 69

PREVALENCE AND RISK FACTORS FOR PELVIC PAIN FOLLOWING MESH IMPLANT SURGERY FOR THE TREATMENT OF PELVIC ORGAN PROLAPSE AND STRESS URINARY INCONTINENCE

E. A. Babb¹; D. Zolnoun¹; A. Nackley²; A. Khan³; E. J. Geller¹

1. Obstetrics and Gynecology, University of North Carolina - Chapel Hill, Chapel Hill, NC, 2. School of Dentistry - Center for Pain Research and Innovation, University of North Carolina - Chapel Hill, Chapel Hill, NC, 3. School of Dentistry - Department of Endodontics, University of North Carolina - Chapel Hill, Chapel Hill, NC

Non-Oral Poster 70

DURATION OF CATHETERIZATION FOLLOWING RETROPUBIC MIDURETHRAL SLING SURGERY

L. L. Johnson¹; B. Dave¹; C. Jaber²; A. Leader-Cramer¹; C. Lewicky-Gaupp¹; M. Mueller¹; K. Kenton¹

1. Female Pelvic Medicine and Reconstructive Surgery, Northwestern University, Chicago, IL, 2. Loyola University Stritch School of Medicine, Chicago, IL

— Non-Oral Posters —

Non-Oral Poster 71

MID-YOUTUBE SLINGS: A SYSTEMATIC APPRAISAL OF SOCIAL MEDIA ON INFORMATION QUALITY, SURGICAL CONTENT AND BIAS ABOUT MID-URETHRAL SLINGS

M. Larouche¹; L. Stothers²; R. Geoffrion¹; D. Lazare¹; A. Clancy³; N. Koenig¹; G. W. Cundiff¹

1. Obstetrics and Gynecology, University of British Columbia, Vancouver, BC, Canada, 2. Urology, University of British Columbia, Vancouver, BC, Canada, 3. Obstetrics and Gynecology, University of Ottawa, Ottawa, ON, Canada

Non-Oral Poster 72

OPERATIVE TIME LONGER THAN 180 MINUTES IN ABDOMINAL HYSTERECTOMY IS PREDICTIVE OF 30-DAY PERIOPERATIVE COMPLICATIONS

T. Catanzarite¹; B. Vieira²; S. Saha²; J. Y. Kim²; M. Milad¹

1. Department of OB/GYN, Northwestern University Feinberg School of Medicine, Chicago, IL, 2. Department of Surgery, Northwestern University Feinberg School of Medicine, Chicago, IL

Non-Oral Poster 73

RISK FACTORS FOR URETERAL OCCLUSION DURING TRANSVAGINAL UTEROSACRAL LIGAMENT SUSPENSION: A RETROSPECTIVE CASE-CONTROL STUDY

I. Montoya; E. Jackson; J. A. Bilbao; R. W. Vera; Z. D. Mulla; V. T. Mallett
Obstetrics and Gynecology, Texas Tech University HSC El Paso, El Paso, TX

Non-Oral Poster 74

PREDICTORS OF POSTOPERATIVE VOIDING TRIAL PERFORMANCE IN PATIENTS UNDERGOING UROGYNECOLOGIC PELVIC FLOOR REPAIR WITHOUT CONCURRENT INCONTINENCE PROCEDURES

S. Won¹; R. Wang¹; E. Von Barga¹; M. Haviland¹; M. R. Hacker¹; E. A. Elkadry²; J. Li¹; R. Lefevre¹

1. Department of Obstetrics and Gynecology, Division of Female Medicine and Pelvic Reconstructive Surgery, Beth Israel Deaconess Medical Center, Harvard Medical School affiliate, Boston, MA, 2. Boston Urogynecologic Associates, Mount Auburn Hospital, Harvard Medical School affiliate, Cambridge, MA

Non-Oral Poster 75

DOES GENITAL HIATUS AND PERINEAL BODY MEASUREMENTS CHANGE WITH INCREASING PROLAPSE STAGE?

G. C. Dunivan; C. S. Ninivaggio; L. Katherine; P. C. Jeppson; Y. Komesu; R. Rogers

Obstetrics and Gynecology, University of New Mexico, Albuquerque, NM

— Non-Oral Posters —

Non-Oral Poster 76

FIRST-IN-HUMAN ACUTE ASSESSMENT OF A NOVEL VAGINAL BOWEL CONTROL SYSTEM FOR THE TREATMENT OF FECAL INCONTINENCE IN WOMEN

E. R. Sokol

Stanford University, Stanford, CA

Non-Oral Poster 77

PERIURETHRAL MASSES IN WOMEN: PRESENTATION, EVALUATION, MANAGEMENT, AND DIAGNOSIS

A. M. Wyman¹; K. A. Greene¹; L. Scott¹; R. Ordorica²

1. Urogynecology and Female Reconstructive Surgery, University of South Florida, Tampa, FL, 2. Urology, University of South Florida, Tampa, FL

Non-Oral Poster 78

RECURRENCE OF URETHRAL DIVERTICULA

A. M. Wyman¹; K. A. Greene¹; L. Scott¹; B. Miladinovic²; R. Ordorica²

1. Urogynecology and Female Reconstructive Surgery, University of South Florida, Tampa, FL, 2. University of South Florida, Tampa, FL

Non-Oral Poster 79

EVALUATION OF THE QUALITY OF SCIENCE PRESENTED AT THE ANNUAL SCIENTIFIC MEETING OF THE SOCIETY OF GYNECOLOGIC SURGEONS

K. Propst; D. M. O'Sullivan; P. Tulikangas

Urogynecology, Hartford Hospital, Hartford, CT

Non-Oral Poster 80

WHAT DO MEN REALLY WANT? A SURVEY OF MALE PERCEPTIONS REGARDING THE VULVA

D. Mazloomdoost; C. C. Crisp; L. B. Westermann; S. D. Kleeman; J. M. Benbouajili; R. N. Pauls

OB/GYN, Trihealth/Good Samaritan, Cincinnati, OH

Non-Oral Poster 81

NON-INDICATED PROPHYLACTIC ANTIBIOTIC USE IN GYNECOLOGIC SURGERY

J. S. Joyce; J. Langsjoen; C. Sharadin; T. Kuehl; W. Larsen

OB/GYN, Baylor Scott and White Healthcare, Temple, TX

Non-Oral Poster 82

PATIENT EXPERIENCE WITH BOTULINIUM TOXIN TYPE A FOR REFRACTORY MYOFASCIAL PELVIC PAIN

K. L. Armstrong^{1,2}; E. Von Barga^{1,2,3}; M. Haviland¹; M. R. Hacker^{1,2}; E. A. Elkadry^{2,3}

— Non-Oral Posters —

1. Department of Obstetrics and Gynecology, Beth Israel Deaconess Medical Center, Boston, MA, 2. Department of Obstetrics, Gynecology, and Reproductive Biology, Harvard Medical School, Boston, MA, 3. Department of Obstetrics and Gynecology, Mount Auburn Hospital, Cambridge, MA

Non-Oral Poster 83

RATE OF DISCREPANCY BETWEEN PREOPERATIVE DIAGNOSIS AND FINAL PATHOLOGY IN HYSTERECTOMIES PERFORMED FOR BENIGN DISEASE

E. R. Trowbridge¹; M. H. Vaughan¹; D. Becker²

1. Obstetrics and Gynecology, University of Virginia Health System, Charlottesville, VA, 2. OBGYN, University of Alabama - Birmingham, Birmingham, AL

Non-Oral Poster 84

CREATION OF A COLLABORATIVE RESEARCH NETWORK FOR JUNIOR INVESTIGATORS

H. W. Brown¹; D. D. Antosh³; J. L. Gleason⁴; S. S. Oliphant⁵; C. Grimes²

1. OB/GYN and Urology, University of Wisconsin School of Medicine & Public Health, Madison, WI, 2. OB/GYN, Columbia University Medical Center, New York, NY, 3. OB/GYN, Methodist Center for Restorative Pelvic Medicine, Houston, TX, 4. OB/GYN, Carilion Clinic - Virginia, Roanoke, VA, 5. OB/GYN, University of Arkansas, Little Rock, AR

Non-Oral Poster 85**

LEARNING THEORIES APPLIED TO MICRO-TEACHING MOMENTS IN THE OPERATING ROOM

G. Sutkin¹; E. B. Littleton²; S. Kanter²

1. Ob/Gyn/RS, University of Pittsburgh, Pittsburgh, PA, 2. University of Pittsburgh School of Medicine, PITTSBURGH, PA

Non-Oral Poster 86

PERIOPERATIVE COMPLICATIONS AND COST OF VAGINAL, OPEN ABDOMINAL, AND ROBOTIC SURGERY FOR APICAL VAGINAL VAULT PROLAPSE

M. Anand¹; A. Weaver²; K. Fruth²; B. Borah³; C. Klingele¹; J. Gebhart¹

1. Department of Obstetrics and Gynecology, Division of Gynecologic Surgery, Mayo Clinic, Rochester, MN, 2. Department of Biomedical Statistics and Informatics, Mayo Clinic, Rochester, MN, 3. Department of Health Sciences Research, Division of Health Care Policy and Research, Mayo Clinic, Rochester, MN

****Member Candidate Presentation**



Donors



Ambassador

\$10,000 - \$24,999

Ed and Deborah Gallup
Pam Gallup

Champion

\$5,000 - \$9,999

Michael P. Aronson Family
Andrew Cassidenti
Cheryl Iglesia
Thomas E. Nolan
Holly E. Richter
R. Edward Varner

Mentor

\$2,500 - \$4,999

James L. Breen
LABORIE

Advocate

\$1,000 - \$2,499

W. Allen Addison
Peter Bulla
Geoffrey W. Cundiff
Nancy Frankel & Lennie Siegel
John Gebhart
LaFloyd and Elaine Hobbs
Stephen Metz
Bob Shull
Kris Strohbehn
Dionysios K. Veronikis
Andrew J. Walter
Sheldon Weinstein



Patron \$1 - \$999

Arnold Advincula	C. Sage Claydon	Kim Gerten
Vivian Aguilar	Jeffrey L. Clemons	Mohamed A.
Mallika Anand	William Cliby	Ghafar
Kathryn Arendt	Sarah Collins	Dobie Giles
Marc Ashby	Jeffrey Cornella	Jon Gleason
Tirsit Asfaw	Andrew Croak	Karen Gold
Jamie Bakkum-	John O. L.	Bobbie Gostout
Gamez	DeLancey	Elliot Greenberg
Alicia Ballard	Gouri Diwadkar	Jerod Greer
Heather Barbier	Sean Dowdy	Meghan Griffin
Matthew Barker	Peter Drewes	Robert Gutman
Ahmet Bedestani	Terry S. Dunn	Douglass Hale
Roberta E. Blandon	Karolynn T. Echols	Cynthia Hall
Joan Blomquist	Mark Ellerkmann	Barry Hallner
Bryce Bowling	David Ellington	Robert Hammer
Linda Brubaker	Sherif El-Nashar	Harriette Hampton
Kristina Butler	Elisabeth Erikson	Star Hampton
Cassandra	Tola Fashokun	Christine Heisler
Carberry	Dee Fenner	John Michael
James Carter	Paul Fine	Heusinkveld
Elizabeth Casiano	Sean Francis	Wesley S. Hilger
Ralph Chesson	Rajiv Gala	Audra Jo Hill



Patron (continued)
\$1 - \$999

Lennox Hoyte	Yoko Komesu	Miles Murphy
Denise Howard	Nicole Korbly	Deborah Myers
William W. Hurd	Abner P. Korn	Mikio Nihira
Okey Ibeanu	Nathan Kow	Michael Noone
Tiffany Jackson	Bela Kudish	Peggy Norton
Karl Jallad	Christine LaSala	Susan Oakley
Van Jenkins	Melinda Letterman	John Occhino
Peter Jeppson	Jaime Long	Marie Paraiso
Lisa Johnson	Mamta Mamik	Amy Park
Padma Kandadai	Andrea Mariani	Candice Parker-
Mickey Karram	Arnulfo Martinez	Autry
Nadine Kassis	Paul McChristian	Rachel Pauls
Kimberly Kenton	George McClure	Lisa M. Peacock
Rosanne Kho	Brook McFadden	Paul D. Pettit
Shunaha Kim Fine	Mary T. McLennan	Antonio Pizarro
Jennifer Klauschie	Carlos A. Medina	Karl C. Podratz
Christopher	Kate Meriwether	Ruchira Singh
Klinge	John Miklos	Ambereen Sleemi
Sharon Knight	Douglas Miyazaki	Scott W. Smilen
Leise Knoepf	Michael Moen	Carl Smith
Anuradha Koduri	Abraham Morse	Andrew Sokol
Yoko Komesu	Tyler Muffly	Eric Sokol
Ernest I. Kohorn	Tristi Muir	Ellen Solomon



Patron (*continued*)

\$1 - \$999

Arlene Song	Elana Tunitsky-	Thomas Wheeler
Karen Soules	Bitton	James Whiteside
Edward Stanford	Cecile Unger	Heather Willis
Kevin Stepp	Babak Vakili	Anne K. Wiskind
Vivian Sung	Brett Vassallo	Joshua Woelk
Karl F. Tamussino	Cliff Wai	Kyle Wohlrab
Bernard Taylor	Mark Walters	Hugh Wolcott
James P.	Briana Walton	Michael Woods
Theofrastous	K. Wang	Johnny Yi
Marc Toggia	Renee Ward	Wong T. Zheng
Emanuel Trabuco	Blair Washington	Carl Zimmerman
Paul Tulikangas	Emily Weber	Dani Zoorob
	LeBrun	



Michael P. Aronson, MD, Fund Donors

Rony Adam	John Gebhart	Stephen Metz
Arnold Advincula	Dobie Giles	Michael Moen
Michael P. Aronson Family	Douglass Hale	Deborah Myers
James L. Breen	Wesley Hilger	Thomas E. Nolan
Linda Brubaker	Lennox Hoyte	Holly E. Richter
Peter Bulla	William W. Hurd	Rebecca Rogers
Andrew Cassidenti	Lisa Johnson	Robert Rogers
Ralph Chesson	Padma Kandadai	Amy Rosenman
Jeffrey Clemons	Mickey Karram	Joy Saini
Jeffrey L. Cornella	Kimberly Kenton	Tatiana Sanses
John O. L. DeLancey	Ernest I. Kohorn	Bob Shull
Peter Drewes	Yoko Komesu	Mitchell Schuster
Mark Ellerkmann	Abner P. Korn	Kris Strohbehne
Elisabeth Erikson	LABORIE	Vivian Sung
Dee Fenner	Christine LaSala	Bernard Taylor
Nancy Frankel & Lennie Siegel	Melinda Letterman	R. Edward Varner
	Jaime Long	Andrew J. Walter
	Arnulfo Martinez	Emily Weber
	George McClure	LeBrun
		Anne K. Wiskind



Donald G. Gallup, MD, Fund Donors

Ed & Deborah Gallup

Pam Gallup

Harriette Hampton

LaFloyd and Elaine Hobbs

Melinda Letterman

Paul McChristian

Stephen Metz

Thomas E. Nolan

Peggy Norton

Karl C. Podratz

William Seifert

Bob Shull

Carl Smith

Sheldon Weinstein

Hugh Wolcott



In Honor Of

*In Honor of Holly Richter for her leadership,
mentorship and friendship.
Kimberly Kenton*

In Memory Of

*In Memory of Niel Jackson
Jeffrey Clemons*

*In Memory of Robin Haff, RN
Miles Murphy*

*In Memory of Thomas Elkins
Marc Toggia*

*In Memory of Ray Lee
Paul Pettit*

Inaugural Michael P. Aronson Scholarship Recipient Jeannette Lager, MD, MPH



Dr. Lager is an assistant professor at University of California, San Francisco. She is a generalist obstetrician and gynecologist and is one of the providers with the UCSF Comprehensive Fibroid Center. Passionate about developing our future health care leaders, Dr. Lager is the Clinical Clerkship Director for Obstetrics and Gynecology for the School of Medicine and works closely with both students and residents. She has received numerous teaching awards and was recently awarded the APGO/CREOG Resident Teaching Award while she was at Baylor School of Medicine.

SGS Membership

— Membership Roster —

Philip D. Abbott, MD**2004**

3700 Rufe Snow Dr.
Fort Worth, TX 76180
817-590-2395
aa2266@aol.com

Husam Abed, MD**2015**

2079 W. Grand Blvd, 8th floor
Detroit, MI 48202
313-916-2454
HABED2@hfhs.org

Rony Adam, MD**2000**

Vanderbilt University Medical Ctr.
Female Pelvic Medicine & Recon
Surgery
B-1100 MCN
Nashville, TN 37232
615-322-8968
r.adam@vanderbilt.edu

Arnold P. Advincula, MD**2006**

622 West 168th Street
PH 16-139
New York, NY 10032
646-317-6890
aa3530@cumc.columbia.edu

Cindy Amundsen, MD**2000**

Duke Univ. Medical Center
5324 McFarland Drive, Suite 310
Durham, NC 27707
919-401-1001
cindy.amundsen@duke.edu

Lily A. Arya, MD**2009**

Hospital of the Univ. of PA/Dept.
OB/GYN
1000 Courtyard
3400 Spruce Street
Philadelphia, PA 19104
215-662-2465
Larya@obgyn.upenn.edu

Charles Ascher-Walsh, MD**2010**

Mt. Sinai Hospital / Dept. OB.GYN
1176 Fifth Avenue, Box 1170
New York, NY 10029
212-241-2827
charles.ascher-walsh@mssm.edu

Arnim Bader, MD**2009**

Medical University of Graz
Auenbruggerplatz 14
Graz, Austria A-8036
43 316 386 81435
arnim.bader@medunigraz.at

Sunil Balgobin, MD**2012**

5323 Harry Hines
Dallas, TX 75390-9032
214-648-6430
sunil.balgobin@utsouthwestern.edu

Matthew Barber, MD**2007**

Cleveland Clinic
9500 Euclid Ave./A81
Cleveland, OH 44195
216-445-0439
barberm2@ccf.org

Joan M. Bengtson, MD**1995**

Brigham & Women's Hospital
850 Boylston Ave., Suite 402
Chestnut Hill, MA 02467
617-732-9300
jbengtson@partners.org

— Membership Roster —

Alfred Bent, MD

2007

PO Box 367
455 Cottage Lane
Brookfield, NS B0N 1C0
902 449 2953
alfred.bent@gmail.com

Todd Beste, MD

2009

SEAHEC OB/GYN
2131 S. 17th Street
Wilmington, NC 28402
910-762-9093
Todd.Beste@seahec.net

Jody Blanco, MD

1995

Columbia Presbyterian Med. Ctr.
161 Fort Washington Ave. #447
New York, NY 10032
212-305-1107
jsb7@columbia.edu

Deirdre Bland, MD

1999

Blue Ridge Medical Associates
201 Executive Park Blvd.
Winston-Salem, NC 27103
336-774-9000
bland.blueridge@gmail.com

Roberta Blandon, MD

2012

4401 Wornall Road
3rd Floor. Peet Center
Kansas City, MO 64111
816-932-1785
rblandon@saint-lukes.org

Joan Blomquist, MD

2014

6569 North Charles Street
PPW S 307
Baltimore, MD 21204
443-849-2767
jblomqui@gbmc.org

Michael Bonidie, MD

2006

300 Halket Street
Pittsburgh, PA 15213
412-641-1440
bonidiej@mail.magee.edu

C. Bryce Bowling, MD

2012

University of Tennessee Med. Ctr
1932 Alcoa Highway, Suite C-450
Knoxville, TN 37920
865-305-5940
cbbowlingmd@gmail.com

Sarah H. Boyles, MD

2009

Urogynecology Associates
9155 SW Barnes Road #634
Portland, OR 97225
503-297-4123
sboyles@orclinic.com

Catherine Bradley, MD

2008

University of Iowa
Dept. OB/GYN
200 Hawkins Dr.
Iowa City, IA 52242
319-356-1534
catherine-bradley@uiowa.edu

J. Michael Breen, MD

1997

2821 Michaelangelo Dr.
Edinburg, TX 78539
423-785-6696
jmbreenmd@gmail.com

Linda Brubaker, MD

1995

2160 S. First Avenue, #417
Maywood, IL 60153
708-216-3960
lbrubaker@luc.edu

— Membership Roster —

Gunhilde M. Buchsbaum, MD

2007

University of Rochester Med. Ctr.
601 Elmwood Ave., Box 668
Rochester, NY 14642
585-273-3232
gunhilde_buchsbaum@urmc.rochester.edu

Richard C. Bump, MD

1989

131 Cub Highland
Nellysford, VA 22958
434 361-1824
rcbump0621@gmail.com

David B. Byck, MD

1995

Memorial Medical Center
4750 Waters Ave. #400
Savannah, GA 31404
912-350-5937
ByckDa1@memorialhealth.com

Ricardo Caraballo, MD

2004

University Urogynecology
Associates
6012 Piazza at Main Street
Voorhees, NJ 08043
856-325-6622
caraballo-
ricardo@cooperhealth.edu

James Carter, MD

2003

Medical University of SC
Dept. OB/GYN
171 Ashley Ave.
Charleston, SC 29425
843-792-4500
carterja@musc.edu

Andrew Cassidenti, MD

2012

1140 W. La Veta, Suite 560
Orange, CA 92868
714-835-0101
abruin4ev@aol.com

Chi Chiung Grace Chen, MD

2012

301 Building Room 3118
4940 Eastern Ave.
Baltimore, MD 21224
410-550-2787
cchen127@jhmi.edu

Ralph R. Chesson, MD

1995

LSU Medical Ctr. OB/GYN
324 Walnut St.
New Orleans, LA 70118
504-412-1600
rchess@lsuhsc.edu

Dennis Chi, MD

2003

Memorial Sloan-Kettering Cancer
Ctr.
1275 York Avenue
New York, NY 10021
212-639-5016
chid@mskcc.org

Hilary J. Cholhan, MD

1995

Women's Continence Ctr. of
Greater Rochester
500 Helendale Rd., Suite 265
Rochester, NY 14609
585-266-2360
hcholhan@choiceonemail.com

— Membership Roster —

C. Sage Claydon, MD

2010

1098 West Baltimore Pike Health
Center 3
Suite 3-404
Media, PA 19063
610-627-4170
info@drclaydon.com

Jeffrey Clemons, MD

2005

Urogynecology & Pelvic
Reconstructive Surgery
1901 S. Union Ave., Suite B-2006
Tacoma, WA 98405
253-301-5120
drclemons@yahoo.com

Sarah Collins, MD

2015

5841 S. Maryland Ave, MC 2050
Chicago, IL 60637
773-834-0358
scollins4@uchicago.edu

Pleas Copas, MD

1999

1932 Alcoa Hwy #150
Knoxville, TN 37920
865-546-1642
pcopas@wc-grp.com

Jeffrey L. Cornella, MD

1995

Mayo Clinic
5777 E. Mayo Blvd.
Phoenix, AZ 85054
480-342-2867
cornella.jeffrey@mayo.edu

Marlene Corton, MD

2011

5323 Harry Hines Boulevard
Dallas, TX 75390
214-648-6430
marlene.corton@utsouthwestern.edu

Bruce S. Crawford, MD

2009

Center for Pelvic Floor Medicine
645 Sierra Rose Dr. #204
Reno, NV 89511
775-352-9355
pf171@live.com

Andrew Croak, DO

2014

625 Gibbs Street
Maumee, OH 43537
419-893-7134
acroak@nwourogyn.com

Stephen H. Cruikshank, MD

1989

884 River Forest Drive
Maineville, OH 45039
513-494-0366
shcbmc@aol.com

Patrick Culligan, MD

2003

435 South St., Suite 370
Morristown, NJ 07960
973-971-7267
patrick.culligan@atlantichhealth.org

Geoffrey W. Cundiff, MD

1998

University of British Columbia/Dept.
OB/GYN
1190 Hornby St.
Vancouver, BC, Canada V6Z1K2
604-806-9966
geoff.cundiff@gmail.com

Vani Dandolu, MD

2007

2040 West Charleston Blvd. #200
Las Vegas, NV 89102
702-671-2300
vdandolu@medicine.nevada.edu

— Membership Roster —

John O.L. DeLancey, MD

1986

Univ. of Michigan Health System
Dept. OB/GYN, Room L4000 WH
1500 E. Medical Center Drive
Ann Arbor, MI 48109
734-764-8429
delancey@umich.edu

Michael P. Diamond, MD

1990

1120 15th Street, BA-7300
Augusta, GA 30912
706-721-3591
Michael.Diamond@gru.edu

Sean C. Dowdy, MD

2009

Gynecologic Surgery
Mayo Clinic
200 First Street, SW
Rochester, MN 55905
507-266-0225
dowdy.sean@mayo.edu

Peter Drewes, MD

2007

585 North 500 West
Provo, UT 84601
801-374-1801
drewes@valleyobgynutah.com

Harold P. Drutz, MD

1996

Mount Sinai Hospital
700 University Ave., Room 8-815
Toronto, Ontario, Canada M5G
1Z5
416-586-4642
hdrutz@mtsinai.on.ca

Gena Dunivan, MD

2013

University of New Mexico
MSC10-5580
1 University of New Mexico
Albuquerque, NM 87131
505-925-4395
gdunivan@salud.unm.edu

Terry S. Dunn, MD

2009

850 E. Harvard Ave. #285
Denver, CO 80210
303-282-0006
tdunnmd@urogyns.com

Renee Edwards, MD

2003

OHSU Mailcode L466
3181 SW Sam Jackson Park Road
Portland, OR 97239
503-494-3107
edwardre@ohsu.edu

Nazanin Ehsani, MD

2014

1130 Hwy 315
Wilkse-Barre, PA 18702
570 706 2170
nazy30@gmail.com

Eman Elkadry, MD

2004

725 Concord Ave. #1200
Cambridge, MA 02138
617-354-5452
eelkadry@mah.harvard.edu

Denise Elser, MD

2001

5716 W. 95th Street
Oaklawn, IL 60453
708-499-9800
delser@whii.org

— Membership Roster —

Elisabeth Erikson, MD

2013

1 Medical Center Drive
Lebanon, NH 03766
603-653-9312
Elisabeth.A.Erikson@hitchcock.org

John Fantl, MD

Charter

Mt. Sinai Medical System
10 Union Square, 2E
New York, NY 10003
631495 0366
fantlja1@gmail.com

Tola Fashokun, MD

2015

4940 Eastern Avenue
Baltimore, MD 21224
410-550-2787
tfashok1@jhmi.edu

Atif Fazari, MD, MPH

2014

UMST- Sudan
Khartoum, Sudan 11111
atiffazari@hotmail.co.uk

Dee E. Fenner, MD

1995

University of Michigan OB/GYN
1500 F. Medical Center Dr., L4000
Women's Hospital
Ann Arbor, MI 48109
734-647-5866
deef@umich.edu

Paul Fine, MD

2009

5121 Oak Court
Dickinson, TX 77539
713-831-6553
paul.fine@ppgulfcoast.org

Robert Flora, MD

2015

16001 W 9 Mile Road
Southfield, MI 48075
488-495-664
robert.flora@stjohn.org

Ray Foster, MD

2014

500 N. Keene St. Ste 306
Columbia, MO 65201
573-817-3165
fosterrt@health.missouri.edu

Arnold J. Friedman, MD

1988

350 East 17th Street
8th Floor, Baird Hall
New York, NY 10003
212-420-4238
afriedma@chpnet.org

Rajiv Gala, MD

2009

Ochsner Medical Center
4429 Clara St. #440
New Orleans, LA 70115
504-842-6680
rgala@ochsner.org

John Gebhart, MD

2006

Mayo Clinic - OB/GYN
200 First Street SW
Rochester, MN 55905
507-266-7711
gebhart.john@mayo.edu

Elizabeth Geller, MD

2014

CB 7570 Old Clinic
Dept Ob/Gyn
Chapel Hill, NC 27599
919-966-4717
egeller@med.unc.edu

— Membership Roster —

Rene Genadry, MD

1992

University of Iowa Hospitals and
Clinics

200 Hawkins Dr. 51233 PFP

Iowa City, IA 52242

319-356-2306

rene-genadry@uiowa.edu

Mohamed Ghafar, MD

2014

2500 North State Street

Jackson, MS 39216

601-984-5314

mghafar@umc.edu

Dobie Giles, MD

2015

600 Highland Ave, H4/658 CSC,
Box 6188

Madison, WI 53792

608-265-9510

giles2@wisc.edu

Elliot Greenberg, MD

2015

Baystate OB/GYN Group

Medical Center Dr. #206

Springfield, MA 01107

413-794-8484

elliottgreenbergmd@gmail.com

Daniel Gruber, MD

2013

11815 Prestwick Rd.

Potomac, MD 20854

301-974-2165

ddgruber1@gmail.com

Robert Gutman, MD

2009

Washington Hospital Center

Dept. OB/GYN

106 Irving St NW, Suite 405 S

Washington, DC 20010

202-877-6526

Robert.E.Gutman@medstar.net

Douglass Hale, MD

2006

Urogynecology Associates

1633 Capital Ave., #436

Indianapolis, IN 46202

317-962-6600

dhale@iuhealth.org

Brittany Star Hampton, MD

2009

695 Eddy Street #12

Providence, RI 02905

401-453-7560

bhampton@wihri.org

Charles R. Hanes, MD

2006

3 Mobile Infirmary Circle, Suite 401

3 Mobile Infirmary Cr. #401

Mobile, AL 36607

251-338-1234

hanes@urogynsa.com

Oz Harmanli, MD

2004

Baystate Medical Center

759 Chestnut St., S-1681

Springfield, MA 01199

413-794-5608

oz.harmanli@bhs.org

Robert Harris, MD

2003

501 Marshall St. #600

Jackson, MS 39202

601-948-6540

rharris@seug.com

Wesley J. Harris, MD

2000

Bristol GYN and OB

200 Skyline Dr.

Bristol, TN 37620

423-968-3033

ickharris1@gmail.com

— Membership Roster —

Christine Heisler, MD

2012

25 Michigan Ste NE Ste. 6200
Grand Rapids, MI 49503
616-391-3304
christine.heisler@spectrum-
health.org

Michael Heit, MD

2000

1633 N Capitol Ave. #436
Carmel, IN 46032
317-962-6600
mheitmd@gmail.com

Wesley Hilger, MD

2009

87 Scripps Drive #310
Sacramento, CA 95825
916-779-1160
whilger@hotmail.com

Robert L. Holley, MD

2001

1700 6th Av South, # 10382
Dept. of OB/GYN
Birmingham, AL 35233
205-996-4780
rholley@uabmc.edu

Adam Holzberg, DO

2010

6012 Main Street
Voorhees, NJ 08043
856-325-6622
adholzberg@gmail.com

Michael Hopkins, MD

1999

2600 Tuscarawas St. #420 W.
Canton, OH 44708
330-994-1280
michael.hopkins@aaltman.com

Nicolette S. Horbach, MD

1997

NorthernVirginia Pelvic Assn.
3289 Woodburn Rd., Suite 320
Annandale, VA 22003
703-698-7100
nhorbach@aol.com

Ira R. Horowitz, MD

1995

Emory University School of
Medicine
Dept. of Gyn/Ob
1639 Pierce Dr., Room 4307
Atlanta, GA 30322
404-727-9876
ihorowi@emory.edu

Denise Howard, MD

2005

PO Box 62450
Abu Dhabi, UAE
971 2 626 9541
drdenhow@gmail.com

Lennox Hoyte, MD

2006

3225 S. Macdill Ave, #129-307
Tampa, FL 33629
813-335-5698
lennox@mindspring.com

Yvonne Hsu, MD

2010

University of Utah HSC
Dept. OB/GYN
30 North 1900 East, Room 2B 200
Salt Lake City, UT 84132
801-581-5490
yvonne.hsu@hsc.utah.edu

William W. Hurd, MD

1995

5704 Fayetteville Rd
Durham, NC 27713
919-572-4673
William.hurd@duke.edu

— Membership Roster —

Cheryl Iglesia, MD

2008

106 Irving Street, NW, Suite 405
South
Washington, DC 20010
202-877-6526
cheryl.iglesia@medstar.net

Margie Kahn, MD

2006

Dept. OB/GYN
1415 Tulane Avenue
New Orleans, LA 70112
504-988-8070
margiekahn@msn.com

Dorothy N. Kammerer-Doak, MD

1999

Women's Pelvic Specialty Care, PC
4705 Montgomery Blvd. NE #201
Albuquerque, NM 87109
505-888-0443
dkd@womenspssc.com

Sarah Kane, MD

2015

4121 Dutchman's Ln. #307
Louisville, KY 40207
502-409-5600
skaneliu@yahoo.com

Mickey M. Karram, MD

1993

The Christ Hospital
8700 Old Indian Hill Rd.
Cincinnati, OH 45219
513-463-2500
Mickey.Karram@thechristhospital.com

Seshadri Kasturi, MD

2015

87 Scripps Dr. #436
Sacramento, CA 95825
916-779-1160
seshkasturi@yahoo.com

Kristinell Keil, MD

2007

4500 East 9th Avenue #420
Denver, CO 80220
303-329-5822
kky@keilurogynecology.com

Kimberly Kenton, MD

2005

Northwestern Medicine, Prentice
Women's Hospital
Dept. OB/GYN
250 East Superior
Chicago, IL 60611
312-472-3874
kkenton@nmff.org

Rosanne Kho, MD

2015

622 W 168th St
PH 16-1361
New York, NY 10032
212-305-0189
rk2803@cumc.columbia.edu

Steven D. Kleeman, MD

2007

3219 Clifton #100
Cincinnati, OH 54220
513-872-4171
steven_kleeman@trihealth.com

John V. Knaus, DO

1993

St. Francis Hospital
Dept. OB/GYN
5747 W. Dempster, Suite 100
Morton Grove, IL 60053
847-663-1030
jknaus007@gmail.com

— Membership Roster —

Yuko Komesu, MD

2009

Univ. of New Mexico HSC
Dept. OB/GYN
2211 Lomas Blvd., NE
Albuquerque, NM 87131
505-272-9702
ykomesu@salud.unm.edu

Abner P. Korn, MD

2003

1001 Potrero Ave, Rm 6D-17
SFGH 6D-17
1001 Potrero Ave.
San Francisco, CA 94110
415-206-5108
korna@obgyn.ucsf.edu

Bela Kudish, MD

2014

2415 N. Orange Ave. #300
Orlando, FL 32804
407-303-1380
belakudish@gmail.com

Wilma Larsen, MD

2005

2001 S. 31st St.
Temple, TX 76508
254-724-5872
wlarsen@sw.org

Christine LaSala, MD

2008

Div of Urogynecology
Hartford Hospital
85 Seymour St., Suite 525
Hartford, CT 06106
860-972-4338
christine.lasala@hhchealth.org

Ted Lee, MD

2009

300 Halket Street
Magee-Womens Hosp. OB/GYN
300 Halket St.
Pittsburgh, PA 15213
412-541-1440
tlee@mail.magee.edu

Gretchen Lentz, MD

2006

University of Washington School of
Med.
Dept. OB/GYN BB-644 HSC
Box 356460
Seattle, WA 98195
206-543-5555
gretchen@u.washington.edu

Barbara Levy, MD

2014

409 12th Street, SW
Washington, DC 20024
202-863-2503
blevy@acog.org

Christina Lewicky-Gaupp, MD

2015

676 N. St. Clair #950
Chicago, IL 60611
312-929-4747
cgaupp@nmff.org

Frank Ling, MD

1993

Women's Health Specialists
7800 Wolf Trail Cove
Germantown, TN 38138
901-682-9222
fling@whsobgyn.com

— Membership Roster —

Gary H. Lipscomb, MD

1993

UTMG Family Medicine
1301 Primacy Parkway
Memphis, TN 38119
901-448-0224
garyhlipscomb@gmail.com

Robert W. Lobel, MD

1999

5 Palisades Dr., Suite 220
Albany, NY 12205
581-438-5538
rwlobel@aol.com

Ernest G. Lockrow, DO

2003

4608 Saul Road
Kensington, MD 20895
301-295-1232
elockrow@aol.com

Jaime Long, MD

2013

301 S. 7th Ave., Suite 1020
West Reading, PA 19611
484-628-8408
jaime.long@readinghospital.org

Vincent R. Lucente, MD

1998

The Institute for Female Pelvic
Medicine
2200 W. Hamilton St., Suite 111
Allentown, PA 18104
610-435-9575
vlucente@fpmiinstitute.com

Paul Magtibay, MD

2006

Mayo Clinic Arizona
5779 E. Mayo Blvd.
3rd Floor Mayo Clinic Specialty
Bldg.
Phoenix, AZ 85054
480-342-2499
magtibay.paul@mayo.edu

Sangeeta Mahajan, MD

2011

Univ. Hospital of Cleveland
11100 Euclid Ave., MAC 5034
Cleveland, OH 44106
214-844-4906
stm9898@gmail.com

Saifuddin Mama, MD, MPH

2015

3 Cooper Plaza, Suite 221
Camden, NJ 08103
856-342-3006
mama-saifuddin@cooperhealth.edu

Mamta Mamik, MD

2015

1176 5th Ave
1 University of New Mexico
New York, NY 10029
212-241-7090
mamta.mamik@gmail.com

Jeffrey Mangel, MD

2011

Metrohealth Medical Center
2500 Metrohealth Dr.
Cleveland, OH 44109
216-778-5890
jmangel@metrohealth.org

Pierre Martimbeau, MD

Charter

Martimbeau Gynecologic Onc., PA
330 Billingsley Rd. #202
Charlotte, NC 28211
704-334-8644
pmartimbeau@carolina.rr.com

Arnulfo Martinez, MD, MPH

2014

Av. Hidalgo 2425-903
Colonia Obispedo
Monterrey, Mexico 64060
81 83186758
amch@cmhidalgo.com

— Membership Roster —

Kristen Matteson, MD

2013

Womens & Infants Hospital
101 Dudley St.
Providence, RI 02905
401-274-1122
kmatteson@wihri.org

Catherine Matthews, MD

2011

UNC Chapel Hill
Dept. OB/GYN
3032 Old Clinic Bldg., CB 7570
Chapel Hill, NC 27599
919-966-4717
catherine_matthews@med.unc.edu

George B. McClure, MD

2003

MultiCare Health Systems
11410 Madera Circle
Lakewood, WA 98499
253-820-7212
georgebmc@comcast.net

Anna McNanley, MD

2015

9855 Hospital Dr. #275
Maple Grove, MN 55369
952-993-6736
mcna@mac.com

S. Gene McNeeley, MD

1998

Advanced Gynecology and Pelvic
Medicine
44555 Woodward Ave. #402
Pontiac, MI 48341
248-858-9620
smcneele@dmc.org

Carlos Medina, MD

2000

Holtz Center 7007, Department of
OB/GYN, University of Miami
Dept. OB/GYN
6885 Cassis Place
Miami, FL 33164
305-585-5160
cmedina@med.miami.edu

Shawn Menefee, MD

2011

3250 Fordham street
San Diego, CA 92120
619-221-6398
menefeesandiego@gmail.com

Stephen Metz, MD

1997

171 Coventry Lane
Longmeadow, MA 01106
413-567-8697
smetz@massmed.org

John R. Miklos, MD

2003

3400-C Old Milton Pkwy. #330
Alpharetta, GA 30005
770-475-4499
johnrmiklos@yahoo.com

Steven M. Minaglia, MD

2008

1319 Punahou St. #824
Honolulu, HI 96826
808-203-6500
minaglia@hawaii.edu

Douglas Miyazaki, MD

2015

114 Charlois Blvd.
Winston Salem, NC 27103
336-765-5470
dwmiyazaki@novanthealth.org

— Membership Roster —

Michael Moen, MD

2003

1875 Dempster St. #665
Park Ridge, IL 60068
847-825-1590
michael.moen@advocatehealth.com

Stephanie Molden, MD

2012

760 Newtown Yardley Road
Newtown, PA 18940
215-504-8900
smolden@fphcenter.com

Abraham Morse, MD

2003

Boston Urogyn
70 Walnut Street
Wellesley, MA 02481
617-340-6446
anmorse@bostonurogyn.com

Tyler Muffly, MD

2015

12361 E 17th Ave
B 198-2
Aurora, CO 80045
303-724-2038
tyler.muffly@ucdenver.edu

Miles Murphy, MD

2008

Institute for Female Pelvic Medicine
1010 Horsham Road, Suite 101
North Wales, PA 19454
215-855-4713
milesmurphy@comcast.net

Deborah Myers, MD

2000

695 Eddy Street
Providence, RI 02903
401-453-7560
dmyers@wihri.org

Charles Nager, MD

2005

9520 Executive Dr, Suite 360
9350 Campus Point Dr.
San Diego, CA 92121
619-543-7900
cnager@ucsd.edu

Mikio A. Nihira, MD

2005

920 Stanton L. Young, WP2430
Dept. OB/GYN
Oklahoma City, OK 73104
405-271-2247
mikio-nihira@ouhsc.edu

Michael Noone, MD

2009

1875 Dempster St. #665
Park Ridge, IL 60068
847-825-1590
mbnoone@mac.com

Peggy Norton, MD

1993

University of Utah Med. Ctr.
Dept. OB/GYN
30 North 1900 East
Salt Lake City, UT 84132
801-587-1950
peggy.norton@hsc.utah.edu

Amy O'Boyle, MD

2010

Walter Reed National Military Med.
Ctr.
8901 Wisconsin Ave
Bethesda, MD 20814
301-400-2469
amyoboyle@aol.com

Cedric Olivera, MD

2013

8714 5th Avenue
Brooklyn, NY 11209
718-6308600
cedric.olivera@mssm.edu

— Membership Roster —

Francisco Orejuela, MD

2012

One Baylor Plaza
BCM610
Houston, TX 77030
832-826-7463
Francisco.Orejuela@bcm.edu

James Orr, Jr., MD

1986

8931 Colonial Center Dr.
Suite 400
Fort Myers, FL 33905
239-334-6626
jorr@rtsx.com

Lesley Otto, MD

2003

Urogynecology Associates
9155 SW Barnes Rd. #634
Portland, OR 97225
503-297-4123
lotto@orclinic.com

Marie Fidela Paraiso, MD

2003

The Cleveland Clinic Foundation
A81, 9500 Euclid Ave.
Cleveland, OH 44195
216-444-3428
paraism@ccf.org

Amy Park, MD

2013

106 Irving St., NW; # 405 South
Washington, DC 20010
202-877-6526
parkamy@gmail.com

Danielle Patterson, MD

2014

800 Washington Street #232
Boston, MA 02111
617-636-5890
dpatterson1@tuftsmedicalcenter.org

Rachel Pauls, MD

2014

3219 Clifton Ave. Ste 100
Cincinnati, OH 45220
513-862-4171
Rachel_Pauls@trihealth.com

Lisa M. Peacock, MDMD

1998

LSU Health Sciences Center
1542 Tulane Ave., 5th Floor
New Orleans, LA 70112
504-568-4850
lpeac1@lsuhsc.edu

Manuel A. Penalver, MD

1989

5000 University Dr. #3300
Coral Gables, FL 33146
305-663-7001
mannypenalver@aol.com

Paul Pettit, MD

2000

Mayo Clinic, Jacksonville
4500 San Pablo Road
2W Cannaday
Jacksonville, FL 32224
904-953-2977
paul.pettit@mayo.edu

Joseph F. Poh, IMD

1997

Women's Health Care Consultants
500 Medical Center Blvd. #365
Lawrenceville, GA 30045
770-962-2051
jpohls@comcast.net

David Quinlan, MD

2014

101 - 1964 Fort Street
Victoria, BC V8R6R3
250-595-1059
davidjquinlan@shaw.ca

— Membership Roster —

James L. Raders, MD

2009

2300 Front Street #400
Melbourne, MN 32901
612 839-3225
jraders@zipperurogyn.com

Gregory Raff, MD

2013

1481 W. 10th St
Indianapolis, IN 46202
317-988-4917
gjraff@iupui.edu

David Rahn, MD

2011

5323 Harry Hines Blvd.
Dallas, TX 75390-9032
214-648-6430
david.rahn@utsouthwestern.edu

George Ralph, MD

2004

Dept. OB/GYN
8700 LKH Leoben
Leoben, Austria 08700
43-3842-401-2382
george.ralph@lkh-leoben.at

Charles R. Rardin, MD

2009

695 Eddy St. #12
Div. Urogynecology & Reconst.
Surgery
Providence, RI 02903
401-453-7560
crardin@wihri.org

Holly E. Richter, MD

2004

1700 6th AV South, Suite 10382
Dept. OB/GYN
Birmingham, AL 35233
205-934-1704
hrichter@uabmc.edu

John W. Riggs, MD

2004

University of Texas - Houston
5152 Linden St.
Bellaire, TX 77401
713-566-4546
john.w.riggs@uth.tmc.edu

Paul A. Riss, MD

2008

Anna Frauer Gasse 2/4
Vienna, Austria
4.3466051662e+012
paul.riss@gmail.com

Marcella L. Roenneburg, MD

2004

Eastern Shore OB/Gyn
223 Phillip Morris Dr.
Salisbury, MD 21804
410-546-2424
atlasofpelvicsurgery@gmail.com

Rebecca Rogers, MD

2001

2211 Lomas Blvd. NE, Dept. of
Ob/Gyn
Dept. of OB/GYN, MSC 10 5580
Albuquerque, NM 87131
505-272-9712
rrogers@salud.unm.edu

Robert M. Rogers, MD

1995

Kalispell Regional Medical Center
75 Claremont St., Suite A
Kalispell, MT 59901
406-752-8282
shirdoc@aol.com

Peter Rosenblatt, MD

2004

725 Concord Ave., Suite 1200
Cambridge, MA 02465
617-354-5452
plrosen@comcast.net

— Membership Roster —

Norman G. Rosenblum, MD

1991

830 Primrose Lane
Wynnewood, PA 19096
215-955-6200
norman.rosenblum@jefferson.edu

Jim W. Ross, MD

2003

262 San Jose St., Suite A
Salinas, CA 93901
831-775-0758
crmfc2012@gmail.com

Tatiana Sanses, MD

2013

22nd S Greene Street
OB/GYN Department
Baltimore, MD 21201
410-328-2385
tsanses@fpi.umaryland.edu

Joseph Schaffer, MD

2001

UT Southwestern Medical Center
5323 Harry Hines Blvd.
Dallas, TX 75390
214-648-7211
joseph.schaffer@utsouthwestern.edu

Megan Schimpf, MD

2012

Dept. OB/GYN
1500 E. Medical Center Dr.
Ann Arbor, MI 48109
734-647-5866
mschimpf@umich.edu

Mitchell Schuster, MD

2012

1304 13th Ave., SE, Ste. B
Decatur, AL 35601
256-355-9711
decobgyn@bellsouth.net

Edward Sherwood, MD

10551 Angelo Tenero Ave.
Las Vegas, NV 89135
easherwoodmd@cox.net

S. Abbas Shobeiri, MD

2009

Unif. Of OK, HSC OB/GYN
PO Box 26901
Oklahoma City, OK 73190
405-271-2247
abbas-shobeiri@ouhsc.edu

Bob Shull, MD

1988

Scott & White Clinic
Dept. OB/GYN
2401 S. 31st Street
Temple, TX 76508
254-724-5872
bshull@sw.org

David Shveiky, MD

2015

Hadassah Medical Center
Dept. OB/GYN Ein Kerem
Jerusalem, Israel 12000
972-2-6777111
dshveiky@gmail.com

Ambereen Sleemi, MD, MPH

2014

22 Prospect Park SW
Brooklyn, NY 11215
917-324-8348
osleemi@yahoo.com

Scott W. Smilen, MD

1999

NYU School of Medicine
150 East 32nd St. 2nd Floor
New York, NY 10016
212-263-0395
scott.smilen@nyumc.org

— Membership Roster —

Andrew Sokol, MD

2011

106 Irving St., NW
Suite 405 South POB
Washington, DC 20010
202-877-6526
asokol72@gmail.com

Eric Sokol, MD

2014

300 Pasteur Drive, Room G302A
Stanford, CA 94305
650-736-4137
esokol@stanford.edu

John W. Spurlock, MD

1997

433 E. Broad St., Unit 1
Bethlehem, PA 18018
610-868-5780
jonthebold@aol.com

Adam Steinberg, DO

2009

Hartford Hospital
Division of Urogynecology
1832 Asylum Ave.
West Hartford, CT 06117
860-670-5161
acsteinberg06@yahoo.com

Keith Stone, MD

1988

Univ. of Florida at Shands
1600 SW Archer Rd.
Gainesville, FL 32610
352-273-7580
stonek@obgyn.ufl.edu

Thomas G. Stovall, MD

1991

Women's Health Specialists
7800 Wolf Trail Cove
Germantown, TN 38138
901-682-9222
tstovall@whsobgyn.com

Kris Strohbehn, MD

2003

Dartmouth-Hitchcock Medical
Center
One Medical Center Drive
Lebanon, NH 03768
603-653-9312
kris.strohbehn@hitchcock.org

Joe T. Stubbs, MD

2008

5356 Reynolds Street Suite 301
Savannah, GA 31405
912-303-0891
stubbs@urogynsavannah.com

Carmen Sultana, MD

2011

NYP Lower Manhattan Hospital
170 William Street, OB/GYN 7th
floor
New York, NY 10038
212-312-5840
cas2043@med.cornell.edu

Robert L. Summitt, MD

1994

Women's Health Specialists
7800 Wolf Trail Cove
Germantown, TN 38138
901-682-9222
rsummitt@whsobgyn.com

Vivian Sung, MD

2009

695 Eddy Street, Lower Level
Dept. OB/GYN
Providence, RI 02903
401-274-1122
vsung@wihri.org

— Membership Roster —

Karl F. Tamussino, MD

1999

Medical University of Graz
Dept. OB/GYN
Auenbruggerplatz 14
Graz, Austria 08036
43-316-385-81068
karl.tamussino@medunigraz.at

James Theofrastous, MD

2000

Western Carolina Women's
Specialty Center
2100 Ridgefield Blvd
Asheville, NC 28806
828-670-5665
theo1@wcwsc.com

Marc Toglia, MD

2004

Urogyn Associates of Philadelphia
Suite 3404, HealthCare Center 3
1098 W. Baltimore Pike
Media, PA 19063
610-627-4170
togliam@verizon.net

Paul Tulikangas, MD

2008

Hartford Hospital/University of
Connecticut
85 Seymour St.
Hartford, CT 06106
860-545-4338
paul.tulikangas@hhchealth.org

James B. Unger, MD

1995

LSU Health Sciences Center
Dept. OB/GYN
1501 Kings Hwy / PO 33932
Shreveport, LA 71130
318-675-5380
junger@lsuhsc.edu

Christine Vaccaro, DO

2011

ATTN: MCHJ-CLG-U
9040 Jackson Ave
Tacoma, WA 98431
253-968-3043
vaccaro.christine@gmail.com

Heather van Raalte, MD

2013

601 Ewing St., Suite B-19
Princeton, NJ 08540
609-924-2230
vanraalte@princetonurogyn.com

R. Edward Varner, MD

1988

1700 6th Av, Suite 10382
Dept. OB/GYN
Birmingham, AL 35233
205-934-5497
evarner@uabmc.edu

Brett Vassallo, MD

2008

1875 Dempster St., Suite 665
Dept. OB/GYN
Park Ridge, IL 60068
847-825-1590
bjvmd@iultd.org

Dionysios K. Veronikis, MD

1999

Mercy Hospital - St. Louis
621 S. New Ballas Rd. #2002-B
St. Louis, MO 63141
314-251-6758
dveronikis@stlgynsurgery.com

Anthony G. Visco, MD

2008

Duke Univ. Medical Center
Dept. OB/GYN
245 Baker House, Trent Dr.
Durham, NC 27715
919-684-3866
anthony.visco@duke.edu

— Membership Roster —

Cliff Wai, MD

2013

5323 Harry Hines Blvd.
Dallas, TX 75390
214-648-6430
clifford.wai@utsouthwestern.edu

L. Lewis Wall, MD, PhD

1996

Washington U School of Medicine
Dept. OB/GYN, Campus Box 8064
660 South Euclid Ave.
St. Louis, MO 63110
314-747-1402
WALLL@wustl.edu

Christopher Walshe, MD

2003

5838 Harbour View Blvd.
Suite 290
Suffolk, VA 23435
757-686-4655
cjwalshe@msn.com

Andrew J. Walter, MD

2001

TPMG
1600 Eureka Road MOB2/3C
Roseville, CA 95661
916-474-2480
andrew.j.walter@kp.org

Mark D. Walters, MD

1990

The Cleveland Clinic Foundation
OB/GYN & Women's Health
Institute
9500 Euclid Ave., Desk A81
Cleveland, OH 44195
216-445-6586
walterm@ccf.org

Renee Ward, MD

2014

1162 21st Avenue South
B-1100 MCN
Nashville, TN 37232
615-322-8968
renee.ward@vanderbilt.edu

Blair Washington, MD

2014

1100 Ninth Avenue
X8-GYN
Seattle, WA 98101
206-223-6191
blairwashington1@gmail.com

Emily Weber LeBrun, MD

2014

1600 SW Archer Road
PO Box 100296
Gainesville, FL 32610
352-273-7660
eweber@ufl.edu

Alison C. Weidner, MD

2005

5324 McFarland Dr Suite 310
240 Baker House
Durham, NC 27707
919-401-1000
weidn001@mc.duke.edu

Thomas Wheeler, IIMD

2009

890 W. Faris Rd. #150
Greenville, SC 29605
864-455-1600
twheeler@ghs.org

James Whiteside, MD

2014

11135 Grandstone Lane
Cincinnati, OH 45249
jlwhiteside@outlook.com

— Membership Roster —

Anne K. Wiskind, MD

1995

1800 Peachtree Rd. #650

Atlanta, GA 30309

678-539-5980

awiskind@gmail.com

Patrick J. Woodman, DO

2009

8620 Lake Clearwater Lane #118

Indianapolis, IN 46240

317-955-6270

Patrick.Woodman@gmail.com

Carl W. Zimmerman, MD

2000

Vanderbilt Univ. School of Medicine

B-1100 Medical Center North

Nashville, TN 37232

615-322-8968

cwzimmer@aol.com

Halina Zyczynski, MD

2013

Magee-Womens Hospital

300 Halket St.

Pittsburgh, PA 15213

412-641-1440

zyczynski@mail.magee.edu

— Life Members —

G. David Adamson, MD

1994
20665 Fourth Street, Suite 201
Saratoga, CA 95070

W. Allen Addison, MD

Charter
PO Box 727
Hillsborough, NC 27278

William S. Alford, DO

2003
4804 Bridlewood cr ne
Canton, OH 44714

Lester A. Ballard, MD

1995
36000 Fairmount Blvd.
Hunting Valley, OH 44022

James G. Blythe, MD

Charter
231 Northwind Dr.
Brandon, MS 39047

John W. Boldt, MD

Charter
The University of Texas Health
Science Center at San Antonio
San Antonio, TX 78229

Edwin A. Bowman, MD

1988
515 Holly Point Road
Freeport, FL 32439

Mark Boyd, MD

1991
Greene Avenue Clinic
1255 Greene Avenue
Montreal, Quebec, Canada H3Z2A4

James L. Breen, MD

Charter
14 N. Calibogue Cay
Hilton Head Island, SC 29928

David S. Chapin, MD

1997
310 Hammond Pond Parkway
Apt 302
Chestnut Hill, MA 02467

Stephen A. Cohen, MD

Charter
Virginia Commonwealth University
Dept. of OB/GYN
Richmond, VA 23298

Joseph T. Crapanzano, MD

1988
Dept. of OB/GYN, GYN Section
LSU School of Medicine
New Orleans, LA 70112

Joseph A. DeCenzo, MD

Charter
10651 SW 77 Avenue
Miami, FL 33156

Bruce H. Drukker, MD

Charter
18242 Lost Creek Lane
Spring Lake, MI 49456

Leo J. Dunn, MD

Charter
Medical College of Virginia
Dept. OB/GYN
Richmond, VA 23298

Paul B. Edmonds, MD

Charter
18315 Salvador Rd.
Edmond, OK 73012

Robert R. Franklin, MD

1989
Obstetrical & Gynecological Assoc.
7550 Fannin St.
Houston, TX 77054

— *Life Members* —

Melvin V. Gerbie, MD

1989
Northwestern University Medical
School
123 West Oak St., Unit O
Chicago, IL 60610

Gerald Glowacki, MD

1997
11210 Old Carriage Road
Glen Arm, MD 21057

Frank C. Greiss, MD

Charter
518 Stonemarker Road
Mooresville, NC 28115

Marvin H. Terry Grody, MD

1990
106 Lombard Street
Philadelphia, PA 19147

Robert Hebertson, MD

Charter
988 Eagle Way
North Salt Lake, UT 84054

Patrick Hogston, MD

2003
11 Brading Ave.
Southsea, Hampshire, UK PO4 9QJ

William J. Hoskins, MD

1988
New York, NY 10021

W. Glenn Hurt, MD

1997
1500 Westbrook Court, Apt. 1143
Richmond, VA 23227

Frederick W. Jelovsek, MD

1992
3520 Homewood Dr.
Johnson City, TN 37604

Van Jenkins, MD

1997
2980 Four Pines Dr #4
Lexington, KY 40502-2978

Thomas Julian, MD

1992
4892 Foxfire Trail
Middleton, WI 53562

Alan L. Kaplan, MD

1988
Baylor College of Medicine
Dept. OB/GYN
Houston, TX 77030

Ernest I. Kohorn, MD

1985
820 Oakwood Road
Dept. OB/GYN
Orange, CT 06477

S. Robert Kovac, MD

1987
Emory University
Dept. GYN/OB
St. Pete Beach, FL 33706

Philip J. Krupp, MD

1986
#6 Swan St.
New Orleans, LA 70124

Eberhard C. Lotze, MD

1987
9333 Memorial Drive, # 105
Houston, TX 77024

Robert Maier, MD

1989
UT Houston Medical School
5656 Kelley St.
Houston, TX 77026

— Life Members —

L. Russell Malinak, MD

Charter
Baylor College of Medicine
Dept. OB/GYN
Brenham, TX 77833

Byron J. Masterson, MD

1987
5121 Hidden Harbor Road
Sarasota, FL 34242

Edwin S. McClain, MD

Charter
2015 Barrel Racer Lane
Carmel, IN 46032

C. Frank McDonell Jr., MD

Charter
210 13th Avenue Place NW
Hickory, NC 28601

Frederick W. McLean, MD

1996
University of Florida College of
Medicine
Dept. OB/GYN
Gainesville, FL 32610

G. Rodney Meeks, MD

1989
207 Audubon Point Dr.
Brandon, MS 39047

Fred S. Miyazaki, MD

1997
5333 Encino Ave.
Encino, CA 91316

John F. Moffett, MD

Charter
2610 E. Levingwood Rd.
Lake Charles, LA 70611

Ana A. Murphy, MD

1993
Medical College of Georgia
Dept. OB/GYN
Augusta, GA 30912

Jonathan M. Niloff, MD

1991
Harvard Medical School
54 Hampshire St.
West Newton, MA 02465

Thomas E. Nolan, MD

1992
403 Pinecrest
Davidson, NC 28036

Robert C. Park, MD

Charter
1115 LeBaron Terrace
Silver Spring, MD 20902

Karl C. Podratz, MD

1986
Mayo Clinic
200 First St., SW
Rochester, MN 55905

Charles Portera, MD

1989
WISH
721 Glenwood Dr.
Chattanooga, TN 37404

Konald A. Prem, MD

Charter
15660 16 Place N.
Plymouth, MN 55447

Brooks Ranney, MD

Charter
Univ. of South Dakota School of
Medicine
Dept. OB/GYN
Yankton, SD 57078

Jack R. Robertson, MD

Founding
1451 N. Refugio Road
Santa Ynez, CA 93460

— Life Members —

John A. Rock, MD

1987

Sr. Vice President of Medical
Affairs, COM

Florida International University
Miami, FL 33199

Robert E. Rogers, MD

Charter

11065 Spice Lane
Fishers, IN 46038

David Sandridge, MD

1996

Grace OB/GYN

2 Yorkshire St.
Asheville, NC 28803

George T. Schneider, MD

Charter

Oshsner Medical Institutions
1514 Jefferson Highway
New Orleans, LA 70121

Richard H. Schwarz, MD

Charter

57 Green Meadow Lane
Huntington, NY 11743

Joseph C. Scott, Jr., MD

1987

1502 South 113 Plaza
Omaha, NE 68144

George L. Sexton, MD

1990

223 Springmont Dr.
Wyomissing, PA 19610

C. Robert Stanhope, MD

Charter Mayo Clinic

Dept. OB/GYN
Rochester, MN 55905

Richard E. Symmonds, MD

Charter Mayo Clinic

Gynecologic & General Surgery
Rochester, MN 55905

O. Eduardo Talledo, MD

1990

Medical College of Georgia

Dept. OB/GYN
Augusta, GA 30912

John D. Thompson, MD

Charter

Dept. OB/GYN
PO Box 7060
Chestnut Mountain, GA 30502

Peter K. Thompson, MD

1995

7550 Fannin
Houston, TX 77054

Robert J. Thompson, MD

1990

8691 San Servera Dr., West
Jacksonville, FL 32217

M. Chrystie Timmons, MD

1990

GERIGYN, PA
32 Plum Tree Lane
Chapel Hill, NC 27517

Daniel A. Triplett, MD

Charter

936 Scott Dr
Liberty, MO 64068

Tom Walker, MD

Charter

602 W. Zenith
Temple, TX 76501

— Life Members —

Anne M. Weber, MD

1998
NICHD
399 Wickford Dr.
Pittsburgh, PA 15238

Sheldon Weinstein, MD

Charter
Presbyterian Hospital of Dallas
8160 Walnut Hill Lane
Dallas, TX 75231

Clifford R. Wheeless, MD

1994
6132 Allwood Court Apt 213
Baltimore, MD 21210

Tiffany J. Williams, MD

Charter
6550 Manasota Key Road
Englewood, FL 34223

Arthur C. Wittich, DO

COL, MC, USA
2001
6725 Catskill Road
Lorton, VA 22079

Stephen B. Young

1995
University of Massachusetts
21 Greene Road
Princeton, MA 01541

— Associate Members —

Melinda Abernethy, MD

Johns Hopkins Bayview
Baltimore, MD 21224
410-550-2787
melabern@gmail.com

Sonia Adams, MD

725 Concord Ave.
Suite 1200
Cambridge, MA 2138
617-354-5452
sradams@mah.harvard.edu

Kerrie Adams, MD

Mail Code L466
3818 SW Sam Jackson Park R
Portland, OR 97239
503-494-3104
adamske@ohsu.edu

Amos Adelowo, MD

641 North Avenue NE
Apt 1318
Atlanta, GA 30308
504-319-4915
amosadelowo@gmail.com

Anubhav Agrawal, MD

550 S. Jackson Street
Louisville, KY 40202
50-256-17260
a0agra05@louisville.edu

Uduak Andy, MD

1000 Courtyard Bldg.
3400 Spruce Street
Philadelphia, PA 19104
215-349-8912
uduak.umoh@uphs.upenn.edu

Tirsit S. Asfaw, MD

1000 Courtyard Bldg
34th St. and Civic Center Blvd.
Philadelphia, PA 19104
215-662-6035
tirsit@yahoo.com

Jessica Balkema, MD

2960 College Dr Ste 2D
Vineland, NJ 8360
856-641-8680
balkemaj@ihn.org

Heather Barbier, MD

8901 Wisconsin Ave
Bethesda, MD 20889
301-400-2468
hbarbier@mac.com

Benjamin Barenberg, MD

OU Physicians Building, 825 NE
10th Street, Suite 5300
Oklahoma City, OK 73104
405-271-9493
benjamin-barenberg@ouhsc.edu

Nina Bhatia, MD

3050 Hamilton Blvd., Suite 200
Allentown, PA 18103
610-435-9575
ninabhatia@gmail.com

Megan Billow, MD

17950 North 68th Street apt 3039
Phoenix, AZ 85054
480-342-0612
meganbillow1@gmail.com

Hema Brazell, MD

85 Seymour Street
MOB 525
Hartford, CT 06106
860-545-4338
hbrazell@harthosp.org

Heidi Brown, MD

University of Wisconsin Hospital &
Clinics
600 Highland Avenue, Box 6188
Madison, WI 53792
608-265-5664
heidi.brown@gmail.com

— Associate Members —

Kristina Butler, MD
5777 East Mayo Blvd
Phoenix, AZ 85054
480-342-2000
butler.kristina@mayo.edu

Elizabeth Casiano, MD
7703 Floyd Curl Drive
San Antonio, TX 78229
210-567-5051
casianoe@uthscsa.edu

Robert Chan, MD
6560 Fannin Street
Houston, TX 77030
713-441-6455
cardinalrcc@gmail.com

Zaid Chaudhry, MD
10833 Le Conte Ave 27-139 CHS
Los Angeles, CA, 90095
310-206-7186
zaidqchaudhry@gmail.com

Heidi Chen, MD
800 Howard Ave., 3rd Floor
New Haven, CT 06519
203-737-3644
heid1013410134@gmail.com

Kathleen Chin, MD
5323 Harry Hines Blvd
Dallas, TX 75390
214-786-7785
kathleenc@gmail.com

Andrea Crane, MD
3023 Old Clinic Bldg
CB 7570
Chapel Hill, NC 27599
919-966-4717
acrane@med.unc.edu

Catrina Crisp, M.Sc.
3219 Clifton Avenue
Cincinnati, OH 45220
513-862-4171
catrina_crisp@trihealth.com

Jacqueline Cunkelman, MD, MPH
2160 S. First Ave.
Bldg 103-1008
Maywood, IL 60153
708-216-2691
09Kathmandu@gmail.com

Laurephile Desrosiers, DO
1176 5th Ave
New York, NY 10029
212-241-1754
ldesrosi@gmail.com

Sybil Dessie, MD
725 Concord Ave, Suite 1200
Ste 1200
Cambridge, MA 02138
617-354-5452
sdessie@mah.harvard.edu

Nicolette Deveneau, MD
550 S. Jackson St
Louisville, KY 40202
502-561-7260
ndeveneau@gmail.com

Alexis Dieter, MD
5324 McFarland Drive, Suite 310
Durham, NC 27710
919-401-1000
alexis.dieter@duke.edu

Benjamin Dillon, MD
5323 Harry Hines Blvd.
Dallas, TX 75390
214-645-8765
benjamin.dillon@utsouthwestern.edu

Omar Duenas, MD
119 Belmont Street
Worcester, MA 01655
508-334-6057
dugof1@hotmail.com

— Associate Members —

Sherif El-Nashar, MD

200 First Street SW
Rochester, MN 55905
507-284-2511
nashar.sherif@mayo.edu

Aisha Elbareg, MD

P O BOX: 2472
TRIPOLI STREET
MISURATAMISURATA
2.1891421361e+011
elbaregsm@hotmail.com

David Ellington, MD

10382 Women's & Infants Center
1700 6th Av South
Birmingham, AL 35233
205-975-3587
davidelling@gmail.com

Anna Frick, MD

East Bay Physicians Medical Group
350 30th Street, #100
Oakland, CA 94609
510/204-8168
africk76@gmail.com

Adam Gafni-Kane, MD

1000 Central Street #730
Evanston, IL 60201
847-570-2750
adamgk@gmail.com

Leda Gattoc, MD

1365 Clifton Rd.
Atlanta, GA 30322
404-778-3401
lgattoc@gmail.com

Karen Gold, MD

1161 21st Ave., South
B1100 MCN
Nashville, TN 37232
615-343-3495
karen-gold@ouhsc.edu

Kristie Greene, MD

1365 Clifton Rd.
Bldg A 4th Floor
Atlanta, GA 30322
404-778-3401
kgree30@emory.edu

Joy Greer, MD

2000 Courtyard Ravdin Bldg.
34th Street & Civic Center Blvd.
Philadelphia, PA 19104
215-662-6035
joy.greer@uphs.upenn.edu

Meghan Griffin, DO

2079 W. Grand Blvd.
Detroit, MI 48202
313-645-9823
mgriffi3@hfhs.org

Cara Grimes, MD

161 Fort Washington Avenue
4th Floor
New York, NY 10032
212-305-1107
clg2173@columbia.edu

Carey Gross, DO

2950 Cleveland Clinic Blvd.
Weston, FL 33331
954-659-5559
carey.gross@gmail.com

Lindsey Hahn, MD

2 Tampa General Circle
Tampa, FL 33606
813-844-8500
hahn.lindsey@gmail.com

Barbara Henley, MD

3032 Old Clinic Bldg.
Chapel Hill, NC 27713
919-966-4717
bhenley@gru.edu

— Associate Members —

Jo Hill, MD

9500 Euclid Avenue - A81
Cleveland, OH 44195
216-445-0439
jolynhill@gmail.com

Diego Illanes, MD

123 Summer Street, Suite 150
Worcester, MA 01608
508-368-3110
illanesd@gmail.com

Stephanie Jacobs, MD

101 The City Drive S
Orange, CA 92868
714-456-8564
jadobssa@uci.edu

Lisa Jambusaria, MD

B1100 Medical Center North
Nashville, TN 37232
615-343-8968
ljambusaria@yahoo.com

Rebecca James, MD

11100 Euclid Avenue LKS 5046
Cleveland, OH 44106
216-844-8570
Rebecca.James@uhhospitals.org

Kelly Jirschele, MD

1875 Dempster
Suite 665
Park Ridge, IL 60068
847-825-1590
kedavis75@aol.com

Sarah Kane, MD

2500 Metrohealth Dr.
Cleveland, OH 44109
216-778-4251
skane@metrohealth.org

Gregg Kanter, MD

2211 Lomas Blvd. NE, Dept. of
OBGYN
Albuquerque, NM 87106
505-272-9712
gkanter@salud.unm.edu

Deborah Karp, MD

2950 Cleveland Clinic Blvd.
Weston, FL 33331
954-659-5559
karpd@ccf.org

Deborah Karp, MD

1639 Pierce Drive, Room 4305
Atlanta, GA 30322
404.712.9673
debby.karp@emory.edu

Elton Kerr, MD

7425 Wrigley Drive, Suite 206
Pasco, WA 99301
509-546-8400
kerr.elton@gmail.com

Shunaha Kim-Fine, MD

Dept. OBGYN, Division
Urogynecology
4th Floor North Tower
1403 29th Street NW
Calgary AB040-)944-1636
skima29@gmail.com

Cara King, DO

600 Highland Avenue
Madison, WI 53792
413-535-8220
cararobinsonking@gmail.com

Casey Kinman, MD

550 S. Jackson St, 3rd Floor Dept
OBGYN
Louisville, KY 40202
817-680-0597
clkinm01@louisville.edu

— Associate Members —

Leise Knoepp, MD

Ochsner Health Center Baptist, Mc
Farland Medical Office Building, Ste
440, 4429 Clara St.
4940 Easatern Ave., 301 Bldg.
3rd Floor
New Orleans ,LA 70115
504-842-6457
lknoepp@gmail.com

Nicole Korbly, MD

695 Eddy St.
Providence, RI 02903
401-453-7560
nkorbly@wihri.org

Nathan Kow, MD

4075 Elnora Drive
Macon, GA 31210
478-633-5300
nathankow@gmail.com

AeuMuro Lake, MD

800 Howard Ave., 3rd Floor
New Haven, CT 06510
203-785-6927
AeuMuro.Lake@umassmemorial.org

Alix Leader-Cramer, MD

250 E. Superior 05-2370
Chicago, IL 60611
312-472-3874
alix-
leadercramer@northwestern.edu

Edgar LeClaire, MD

SP 241- 920 Stanton L Young Blvd.
Oklahoma City, OK 73104
405-271-8787
edgar-leclair@ouhsc.edu

Dominic Lee, MD

5323 Harry Hines Blvd.
Dallas, TX 75390
214-648-9397
dominic.lee@utsouthwestern.edu

Juraj Letko, MD

1000 Central St., Suite 730
Evanston, IL 60201
847-570-2750
jletko@northshore.org

Fiona Lindo, MD

OB/GYN Department-FPMRS
2401 S31st Street
Temple, TX 76508
850-519-6960
feelindo@yahoo.com

Quinn Lippmann, MD

9350 Campus Point Drive, Ste 2A
MC 0974
La Jolla, CA 92307
919-357-3002
qlippmann@ucsd.edu

Danielle Marshall, MD

110 Irving St., NW
POB North Suite 2100
Washington, DC 20010
202-877-6526
danimarshall@hotmail.com

Jason Massengill, MD

8901 Wisconsin Ave.
Bethesda, MD 20889
301-400-1303
jason.massengill@gmail.com

Shyama Mathews, MD

Mount Sinai School of Medicine,
1176 Fifth Avenue, Box 1170
New York, NY 10029
212 241 7090
shyama.mathews@MOUNTSINAI.ORG

Donna Mazloomdoost, MD

3219 Clifton Ave, MOB Suite #100
Cincinnati, OH 45206
513-862-4171
Donna_Mazloomdoost@trihealth.com

— Associate Members —

Erin Mellano, MD

1400 California Ave.
Santa Monica, CA 90403
emellano@mednet.ucla.edu

Kate Meriwether, MD

2211 Lomas Blvd, NE
Albuquerque, NM 87131
505-249-5967
meriwet2@salud.unm.edu

Isuzu Meyer, MD

619 19th St South, 176F Suite
10382
Birmingham, AL 35249
205-996-9580
Imeyer@uabmc.edu

Jeannine Miranne, MD

National Center for Advanced
Pelvic Surgery
106 Irving St NW
POB Suite 405 South
Washington, DC 20010
202-877-6526
Jeannine.M.Miranne@medstar.net

Kavita Mishra, MD

101 Dudley St.
Providence, RI 02905
401-453-7560
kmishra@wihri.org

Darlene Morrissey, MD

207 N. Broad Street, 4th Floor
Philadelphia, PA 19107
dmorrissey@westernu.edu

Margaret Mueller, MD

2160 S. First Ave., Bldg. 103
Room 1008
Maywood, IL 60137
847-275-3757
maggie.mgmueller@gmail.com

Maggie Mueller, MD

250 E Superior St, Suite 5-2370
Bld 103, Rm 1008
Chicago, IL 60611
312-472-3874
mmueller@nmff.org

John Navas, MD

1000 W. Carson St. Box 3
Torrance, CA 90509
310-222-2997
jjnavas1607@icloud.com

Patrick Nosti, MD

8901 West 74th Street, Suite 350
Suite 2100
Shawnee, KS 66204
913-262-3000
patrick.nosti@gmail.com

Susan Oakley, MD

1400 North Grand Ave
Fort Thomas, KY 41071
859-757-2132
oakley.susan@gmail.com

Sujatha Pathi, MD

2215 Cedar Springs Rd.
Apt. 1914
Dallas, TX 75201
323-829-7854
sujipathi@gmail.com

Stephanie Pickett, MD

920 SL Young Blvd.
PO Box 26901, WP24410
Oklahoma City, OK 73104
405-271-9493
stephdeterpickett@gmail.com

Michael Polin, MD

5324 McFarland Dr, Suite 310
Durham, NC 27707
michael.polin@duke.edu

— Associate Members —

Oliver Preyer, MD

Paracelsusstrasse 8
Zell am See
Austria
0+43 664 411 77 88
oliver.preyer@gmail.com

Jameca Price, MD

3181 SW Sam Jackson Park Rd,
Mail Code: L466
Portland, OR 97239
50-349-43107
jamecaprice@gmail.com

Salma Rahimi, MD

1176 Fifth Ave. Box 1170
Dept OB/GYN, 9th Floor
New York, NY 10029
212-241-3703
salma_rahimi@hotmail.com

Olga Ramm, MD

2160 S. First Ave.
Dept OB/GYN
Maywood, IL 60153
708-216-2170
olgaramm@gmail.com

Álvaro Duran Rosales, MD

Madrid, Spain 28002
64-506-0299
alvaroduranr@yahoo.com

Cristina Saiz Rodriguez, MD

3050 Hamilton Blvd., Suite 200
Allentown, PA 18103
610-435-9575
crismsaiz@yahoo.com

Lauren Scott, MD

2 Tampa General Circle, 6th floor
Tampa, FL 33606
lscott1@health.usf.edu

Saya Segal, MD

1000 Courtyard, HUP
3400 Spruce Street
Philadelphia, PA 19104
215-349-5844
Saya.Segal@uphs.upenn.edu

Miriam Seitz, MD

9650 Gross Point
Skokie, IL 60076
224-251-2374
miriamjseitz@gmail.com

Jonathan Shaw, MD

695 Eddy Street
Providence, RI 02903
401-453-7560
shaw.jonny@gmail.com

Katelyn Smithling, MD

106 Irving St, POB suite 405
c/o Barbara Mccaffrey,
Medical Education
Washington, DC 20010
315-771-7685
katelyn.smithling@gmail.com

Megan Tarr, MD

2160 South First Ave.
Bldg. 103, 1008
Maywood, IL 60153
708-216-2365
megan.tarr@gmail.com

Alison Tate, MD

Harbor UCLA Medical
1000 W. Carson St.
Dept. OB/GYN Box 489
Torrance, CA 90509
310-222-3868
alisonltate@yahoo.com

— Associate Members —

Alejandro Treszezamsky, MD

1176 Fifth Ave.
Box 1170
New York, NY 10029
212-241-1754
atreszezamsky@ciwh.org

Emily Von Bargaen, MD

725 Concord Ave
Cambridge, MA 02138
617-354-5452
Emily.vonbargaen@gmail.com

Manhan Vu, DO

1000 Central Street #730
Evanston, IL 60201
847-570-2750
avu817@northshore.org

Lauren Westermann, MD

3219 Clifton Ave.
Suite 100
Cincinnati, OH 45220
513-862-7265
lauren_westermann@trihealth.com

Cheau Williams, MD

18100 Oakwood Blvd.
Suite 213
Dearborn, MI 48124
313-982-0200
cheau.williams@gmail.com

Kathryn Williams, MD

865 Northern Blvd Suite 202
Great Neck, NY 11021
516-622-5114
katshawill@gmail.com

Joshua Woelk, MD

205 S. Wabasha
Saint Paul, MN 55107
651-293-8117
Joshua.Woelk@Parknicollet.com

Sarah Woods, MD

385 Meadvale Rd.
Memphis, TN 38120
(208) 360-0185
woods.sarah.md@gmail.com

Allison Wyman, MD

3815 W. San Juan St
Tampa, FL 33629
440-227-2712
awyman@health.usf.edu

Sallis Yip, MD

310 Cedar St.
New Haven, CT 06510
sallis@gmail.com

Ladin Yurteri-Kaplan, MD

9103 Franklin Square Drive
Suite 305
Baltimore, MD 21237
443-777-8218
ladin.yurteri-kaplan@medstar.net

Dani Zoorob, MD

2123 Auburn Ave., Suite 307
Cincinnati, OH 45219
413-585-3474
dani.zoorob@thechristhospital.com

— Honorary Members —

Anthony Atala, MD

Wake Forest Univ.
Baptist Hospital
Medical Center Blvd.
Winston-Salem, NC 27157

James Bagian, MD

21537 Holmbury
Northville, MI 48167

Sandra Carson, MD

409 12th Street, SW
Washington, DC 20024

William A. Cliby, MD

Mayo Clinic Dept. OB/GYN
200 First Street, SW
Rochester, MN 55905

I. Kelman Cohen, MD

Medical College of Virginia
PO Box 980154
Richmond, VA 23298

Nancy W. Dickey, MD

147 Joe H. Reynolds Medical Bldg.
College Station, TX 77843

Norman F. Gant, MD

3425 Lookout Court
Grapevine, TX 76051

Alan E. Guttmacher, MD

Director, Eunice Kennedy Shriver
NICHD
Bethesda, MD 20892

Katherine Hartmann

2525 West End Avenue
Suite 600
Nashville, TN 37203

Richard E. Hawkins, MD

ABMS
222 N. LaSalle St., Suite 1500
Chicago IL, 60601

Paul Hilton, MD

Directorate of Women's Services
Royal Victoria Infirmary
Newcastle upon Tyne UK NE1 4LP

Shukri Khuri, MD

Brigham and Women's Hospital
VA Boston Healthcare System
West Roxbury, MA 02132

Clifford Ko, MD

633 N. St Clair
Chicago, IL 60611

Heinz Koelbl, MD

Johannes-Gutenberg University
Germany

Hal Lawrence

409 12th Street SW
Washington, DC 20024

Susan Meikle

8901 Wisconsin Ave
Bethesda, MD 20889

Ichiro Nagata, MD

Dept. OB/GYN
Saitama Medical School
Saitama 359-0041 Japan

Ingrid Nygaard

30 N 1900 East
Salt Lake City, UT 84132

Steven Palter, MD

246 Crossways Park Drive West
Woodbury, NY 11797

Richard M. Satava, MD

University of Washington
School of Medicine
Department of Surgery
Seattle, WA 98111

—*In Memoriam*—

Michael Aronson, MD
Wayne F. Baden, MD
Hugh R.K. Barber, MD
Robert H. Barter, MD
John Brewer, MD
Herbert J. Buchsbaum, MD
Edward B. Cantor, MD
Joel Childers, MD
Sterling Crawford, MD
William E. Crisp, MD
Thomas Elkins, MD
Charles E. Flowers, MD
Edward G. Friedrich, Jr., MD
Donald G. Gallup, MD
Celso-Ramon Garcia, MD
Caterina A. Gregori, MD
C. Paul Hodgkinson, MD
Frederick J. Hofmeister, MD
W. Powell Hutcherson, MD
W. Byron Inmon, MD
John Isaacs, MD
Neil D. Jackson, MD
George E. Judd, MD
Kermit Krantz, MD
Henry H. Lansman, MD
Stephen L. Larson, MD
Thomas Leavitt, Jr., MD
Frederick Y.L. Lee, MD
Raymond A. Lee, MD
William A. Little, MD
Oscar Litwak, MD
Robert J. Luby, MD

Abe Mickal, MD
George W. Mitchell, MD
John McLean Morris, MD
George W. Morley, MD
David H. Nichols, MD
Roy T. Parker, MD
Warren E. Patow, MD
Jack W. Pearson, MD
Robert F. Porges, MD
Charles Powell, MD
Joseph H. Pratt, MD
A. Cullen Richardson, MD
Bobby A. Rimer, MD
Euan G. Robertson, MD
Stanley F. Rogers, MD
Keith P. Russell, MD
Thomas Russell, MD
Richard J. Scotti, MD
David C. Sabiston, MD
Martin L. Stone, MD
Donald P. Swartz, MD
M. Leon Tancer, MD
Richard TeLinde, MD
John C. Weed, Jr., MD
Charles A. White, MD
George D. Wilbanks, MD
Winfred Wiser, MD
Benjamin H. Word, MD
James P. Youngblood, MD
J. Benjamin Younger, MD
Robert F. Zacharin, MD

2015 Exhibitors

— 2015 Exhibitors —

ACell

Booth #20

MatriStem® products are medical devices that maintain and support a healing environment through constructive remodeling. MatriStem is comprised of naturally-occurring urinary bladder matrix (UBM), contains an intact epithelial basement membrane and multiple collagens, is non-crosslinked, acellular, and completely resorbable

American Urogynecologic Society

Booth #12

The American Urogynecologic Society (AUGS), founded in 1979, is the premier non-profit organization representing more than 1,800 members including practicing physicians, nurse practitioners, physical therapists, nurses and health care professionals, as well as researchers from many disciplines, all dedicated to treating female pelvic floor disorders. As the leader in Female Pelvic Medicine and Reconstructive Surgery, AUGS promotes the highest quality patient care through excellence in education, research and advocacy.

AMS

Booth #21

American Medical Systems (AMS), headquartered in Minnetonka, Minn., is a diversified supplier of medical devices and procedures to treat incontinence, prolapse and other pelvic disorders in men and women. AMS continues to develop new therapies to restore bodily functions enabling people to regain

control of their lives. These therapies provide new options for patients, providers and payers, and are often inspired by the urologists, gynecologists and urogynecologists who choose AMS as their solutions partner.

BK Ultrasound

Booth #17

BK Ultrasound systems are designed for the surgical suite. Supporting a comprehensive range of sterilizable transducers, Flex Focus systems are compact, lightweight and available with a wireless remote control. They offer up to four hours of battery power and exceptional image quality.

Boston Scientific

Booths #1 and #2

Boston Scientific is dedicated to transforming lives through innovative medical solutions that improve the health of patients around the world. The Urology and Women's Health division provides devices for the diagnosis and treatment of female urinary incontinence and pelvic floor reconstruction. Please visit our exhibit to learn about our newest technologies.

— 2015 Exhibitors —

Bovie Medical Corporation Booth #19

Bovie Medical will be featuring J-Plasma® - the helium-based, gas plasma technology that is transforming the way surgeries are performed. See for yourself how J-Plasma® works with precision and versatility across open and laparoscopic gynecological procedures. Bovie will also exhibit its complete line of electrosurgical generators, PTFE-coated electrodes, and laparoscopic instruments.

Caldera Medical Booth #3

Caldera Medical is a Women's Health medical device company which focuses on improving the quality of life for women. Caldera Medical develops, manufactures and markets differentiated surgical implants for the treatment of Stress Urinary Incontinence (Desara®,® Sling System) and Pelvic Organ Prolapse (Vertessa®,® Lite).

Coloplast Booth #25

With a 50-year legacy of commitment and dedication to female pelvic health, Coloplast offers innovative solutions for the treatment of SUI and POP, featuring products such as the Altis® Single Incision Sling System, Aris® and Supris® full length slings, Restorelle Smartmesh®, the Meridian Vaginal Positioning System, the Digitex® Suture Delivery System.

Cooper Surgical Booth #30

CooperSurgical is the leading provider of innovative medical devices and procedure oriented solutions that advance the standard of care for women. Our highly reliable and clinically relevant products and services facilitate the delivery of enhanced outcomes for your patients regardless of the clinical setting. Come visit us at booth 30 to interact with our industry leading solutions and experience why CooperSurgical is at the forefront of women's health care.

C-SATS, Inc. Booth #11

C-SATS is a system for continuously evaluating and improving performance of all practitioners 90% faster and more affordably than other methods.

Cynosure Booth #14

Cynosure, leads the world in aesthetic laser technologies and research, creating innovative, safe, and efficacious procedures for the treatments patients want most, including hair removal, treatment of vascular and pigmented lesions, skin revitalization, tattoo removal, laser lipolysis to remove unwanted fat, and the reduction in the appearance of cellulite.

— 2015 Exhibitors —

ellura

Booth #8

ellura is changing the way UTIs are managed. ellura is the only non-antibiotic alternative for UTI prevention that has been proven in published clinical trials. Come by our booth to learn more about our mission to reduce dependency on antibiotics for UTI management www.myeellura.com

Ethicon

Booth #15

Ethicon US LLC, brings to market a broad range of innovative surgical products, solutions and technologies used to treat some of today's most prevalent medical issues, such as: colorectal and thoracic conditions, spine and cardiovascular conditions, cancer, obesity and other conditions requiring general surgery. Learn more at www.ethicon.com.

Halo Medical Technologies

Booth #12

Pelvic Floor Ultrasound. Affordable, intelligent ultrasound provides gold standard diagnostics for fecal incontinence, plus easy visualizing of surgical mesh. Portable and all-in-one cart models. 360° Endoanal, Transperineal, and Vaginal probes. Proprietary, high-quality imaging software with full-featured video recording. Comprehensive reporting. Entire system costs less than a probe in competitive products!

Intuitive Surgical

Booths #9 and #10

Intuitive Surgical is the global leader in minimally invasive,

robotic-assisted surgery. Its *da Vinci*® Surgical System – with a 3D-HD vision system and *EndoWrist*® instrumentation – enables surgeons to offer a minimally invasive approach for a range of complex procedures. *da Vinci* is used in more than 2,500 hospitals around the world.

KARL STORZ Endoscopy-America, Inc.

Booth #24

KARL STORZ has remained a leader in minimally invasive endoscopy products for nearly 70 years and offers a range of exceptional gynecological products. Among our technology solutions are EndoCAMeleon® laparoscopes with variable direction of view, RoBi® bipolar laparoscopic forceps, trauma-reducing minilaparoscopy instrument sets, and state-of-the-art OR and office hysteroscopy equipment.

LABORIE

Booth #26

LABORIE, the global leader in Urodynamics, provides you with the most advanced solutions in Pelvic Floor Diagnostics and Treatments. LABORIE delivers innovative products including Wireless Urodynamics, Pelvic Floor Rehabilitation, portable Bladder Scanning, Cystoscopic Injection Needles, EHR integration, Diagnostic Testing for fecal incontinence and much more to create a comprehensive Pelvic Floor Center.

— 2015 Exhibitors —

Mallinckrodt Pharmaceuticals **Booth #6**

Mallinckrodt Pharmaceuticals is an industry leader in providing specialty biopharmaceutical products used in the treatment of autoimmune and rare disease specialty areas, pain and related conditions, and diagnostic procedures. The company's three specialty pharmaceutical segments include; branded medicines, generic drugs and global medical imaging. Visit www.mallinckrodt.com to learn more.

Marina Medical Instruments **Booth #28**

Marina Medical Instruments designs, manufactures, and distributes medical devices for gynecology, uro-gynecology, and pelvic reconstructive surgery. Our innovative product line consists of diagnostic and surgical instrumentation and a full offering of Stille surgical instruments. Se habla espanol.

Medtronic **Booth #23**

At Medtronic, we're committed to Innovating for life by pushing the boundaries of medical technology and changing the way the world treats chronic disease. Products include the InterStim® System, providing Sacral Neuromodulation for Bladder Control and Bowel Control.

OBG Management **Booth #5**

OBG Management, a monthly publication, offers evidence-based best practices that help ObGyns provide optimal patient care. Guided by Editor-in-Chief Robert L. Barbieri, MD, print editorial is reinforced by interactive technique and commentary videos and audiocasts at www.obgmanagement.com. Topics include surgical and diagnostic techniques, standards of care, new technologies, medicolegal and practice-management information, and more.

Olympus **Booth #7**

Olympus is advancing minimally invasive surgical solutions designed to help Gynecologists Oncologists improve clinical outcomes through our innovative world's only imaging and energy technologies. Our commitment to clinical support, professional education, flexible service and financing packages, and knowledgeable local account management make Olympus the partner of choice.

Pacira **BOOTH #16**

EXPAREL® (bupivacaine liposome injectable suspension) is a non-opioid local analgesic indicated for administration into the surgical site to produce postsurgical analgesia. EXPAREL combines bupivacaine with the DepoFoam® drug delivery platform to provide postsurgical pain control with a single intraoperative infiltration.

— 2015 Exhibitors —

Richard Wolf Medical Instruments Corporation

Booth #22

Come and discover the spirit of excellence with Richard Wolf's complete line of innovative and minimally invasive surgical products. We offer the solution to your gynecological needs, ranging from hysteroscopy, resection, fluid management, laparoscopy, and imaging. Stop by the Richard Wolf booth for more information or to schedule an evaluation.

Surgiquest

Booth #4

SurgiQuest, Inc. is the maker of The AirSeal® System, the world's first and only integrated access system for Minimally Invasive Surgery that provides stable pneumo, continuous smoke evacuation, and valve-free cavity access to enhance surgeon capabilities, improve anesthesia parameters, protect OR staff, and reduce OR time in both robotic and laparoscopic surgery. SurgiQuest, Inc.; 333 Quarry Road; Milford, CT 06460 USA; Phone: 203-799-2400; Fax: 203-799-2401; www.surgiquest.com

The Prometheus Group

Booth #29

Introducing the Morpheus system for Pelvic Muscle Rehabilitation, Complex Urodynamics, Endorectal, Endovaginal and Perineal Ultrasound. One Hardware Architecture, One Software Platform.

ThermiGyn

Booth #18

ThermiGyn, a wholly owned subsidiary of ThermiHealth, provides advanced technology using finely controlled thermal energy. The multi-use platform promotes increased patient safety and clinical effectiveness, while providing versatile micro-invasive and non-invasive solutions for Obstetricians and Gynecologists serving the women's health marketplace. Please visit us at www.thermi.com.

Uroplasty

Booth #27

Uroplasty provides transformative treatment options for voiding dysfunctions. Urgent® PC is a low risk, office-based treatment for OAB that delivers exceptional results. Included in the AUA/SUFU OAB guideline. Macroplastique® is a proven bulking agent indicated for adult female SUI. Efficacy, safety, durability supported by over 15 years of global experience.

— SGS Administrative Staff —

Nancy Frankel, MBA

Executive Director

nancy@sgsonline.org

Lennie Siegel, BBA, CPA

Meeting Manager

lennie@sgsonline.org

Melinda Letterman

Executive Administrator

melinda@sgsonline.org

Mailing Address

7800 Wolf Trail Cove

Germantown, TN 38138

Phone

(901) 682-2079

Fax

(901) 682-9505

Website

www.sgsonline.org



SOCIETY OF
GYNECOLOGIC SURGEONS

— **Notes** —

— **Notes** —

Altis®

Single Incision Sling System



Strength runs in the family.



Arís®
Transobturator
Sling System



The Altis® adjustable sling allows
for transobturator placement
with a single incision approach.



Supris®
Retropubic
Sling System

Indications

The Altis Single Incision, Arís® Transobturator and Supris® Retropubic Sling Systems are indicated for the treatment of female stress urinary incontinence (SUI) resulting from urethral hypermobility and/or intrinsic sphincter deficiency (ISD).

Contraindications

It is the responsibility of the surgeon to advise the prospective patients or their representatives, prior to surgery, of the contraindications associated with the use of the Altis, Arís or Supris slings.

Warnings and Precautions

It is the responsibility of the surgeon to advise the prospective patients or their representatives, prior to surgery, of the possible warnings and precautions associated with the use of this product and the associated surgical risks. Altis, Arís and Supris Sling Systems should only be used by surgeons who are qualified to perform this type of surgery, have experience in the surgical treatment of SUI and who are familiar with the use of non-absorbable mesh and the specific insertion technique. The patient should be informed that any future pregnancy may negate the benefits of this surgical procedure and the patient may become incontinent again. Patients should immediately report any onset of bleeding, pain, vaginal discharge or sign of infection that occurs at any time.

Adverse Effects

Potential adverse reactions are those associated with surgery using implantable synthetic mesh materials. As with all foreign bodies, the Altis, Arís, Supris sling is likely to exacerbate any existing infection. Transitory local irritation at the wound site and a foreign body response may occur. There is also the risk of complete failure of the procedure resulting in continued incontinence due to incomplete support or overactive bladder. The occurrence of these events may require partial or complete removal of the sling. Patients should be monitored regularly after the device has been implanted for immediate treatment of any adverse reaction.

See the device manual for detailed information regarding the implant procedure, warnings /precautions, adverse reactions, prior to using this product. For further information, call Coloplast Corp at 1-800-258-3476 and/or consult the company website at www.coloplast.us.

Caution: Federal law (USA) restricts this device to sale by or on the order of a physician.

— Mark Your Calendar —

**24th Annual Postgraduate Course
in Advanced Gynecologic Surgery
Hands-On Cadaveric Workshop
December 2-4, 2015
Florida Hospital/Nicholson Center
Celebration, Florida**



**42nd SGS Annual Scientific Meeting
April 10-13, 2016
Renaissance Indian Wells
Palm Springs, California**

